

SONIC|blue™

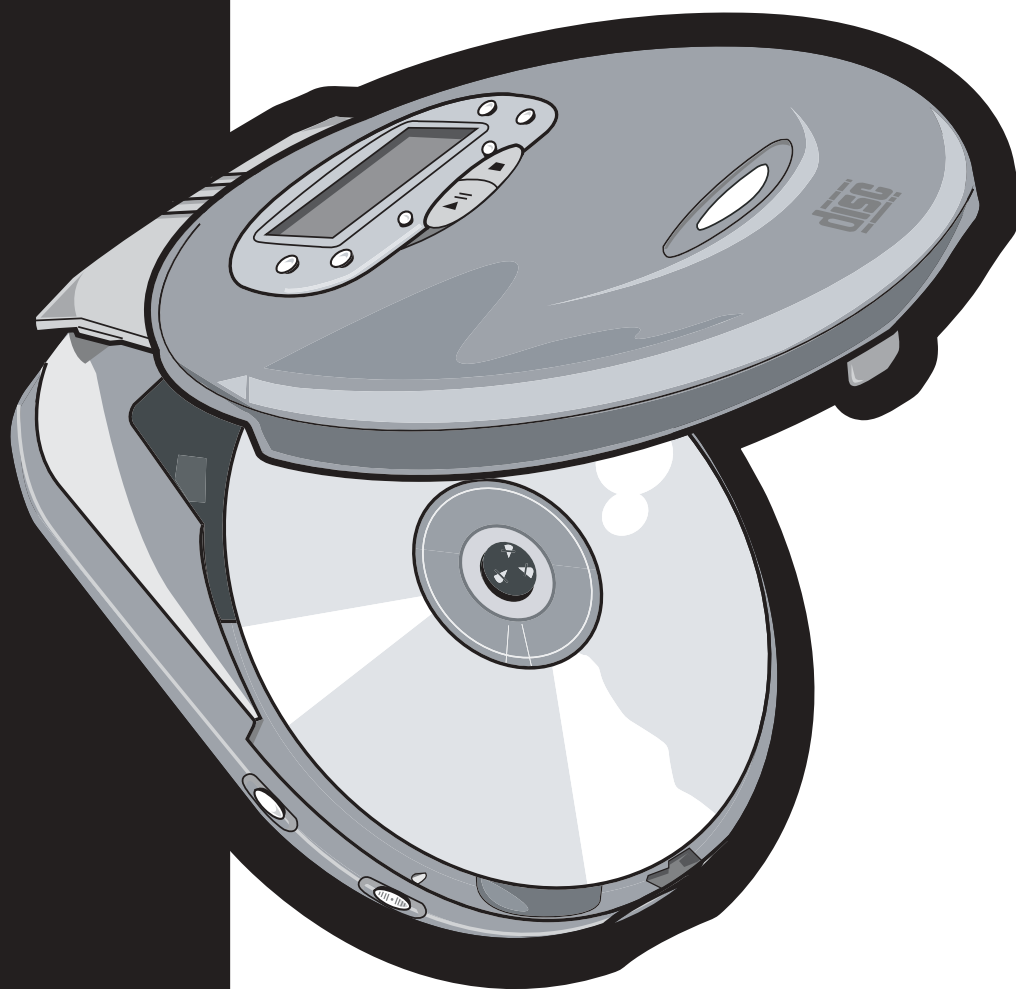

Riōvolt™
mp3 » cd player
SP50/SP50C
User's Guide

Table of Contents

Package Contents	3
Welcome	4
Player Overview	5
LCD Overview	6
Advanced Features	7
Special MP3 Features	9
FAQs	10
Technical Specifications	12
Customer Care	13
Warranty	14
Important Safety Information	15

Package Contents



[†]Included with SP50C Only

Welcome

Welcome to the RioVolt SP50/SP50C, your complete portable solution for audio CD and MP3 playback. The RioVolt includes ESP (Electronic Shock Protection), which buffers up to two minutes of digital audio to prevent skipping. Follow these steps to get started:

1 Unpack

Make sure your player includes the following accessories (see page 3):

- Two AA-size batteries
- Earphones
- Quick Start Guide
- Car Cassette Adapter (SP50C only)
- Car Power Adapter (SP50C only)
- Flickerstick CD (SP50C only)

2 Insert Batteries

1. Slide open the battery cover (see page 4).
2. Insert the two supplied AA batteries, paying attention to the correct polarities (+ and -).
3. Replace the battery cover.

3 Connect Earphones

- Connect the supplied earphones to the HEADPHONE jack  on the side of the player.
- Tip: You can also use the LINE OUT jack to connect the player to an external audio system.



4 Insert Disc

1. Press the OPEN button to release the latch and open the CD cover.
2. Insert an audio CD or MP3 CD into the player, label side up.
3. Close the CD cover.

Note: The RioVolt SP50/SP50C can play CDs with the following logos:



5 Play Disc

1. Press the PLAY/PAUSE  button to turn on the player and begin playback.
Note: There will be a short delay while the player reads the tracks on the CD.
2. Press the STOP  button to stop playback. Press STOP again to turn off the player.

Player Overview

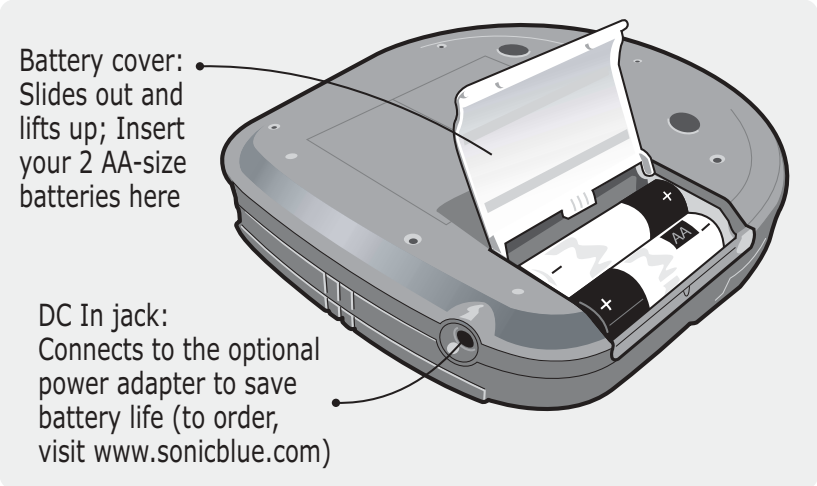
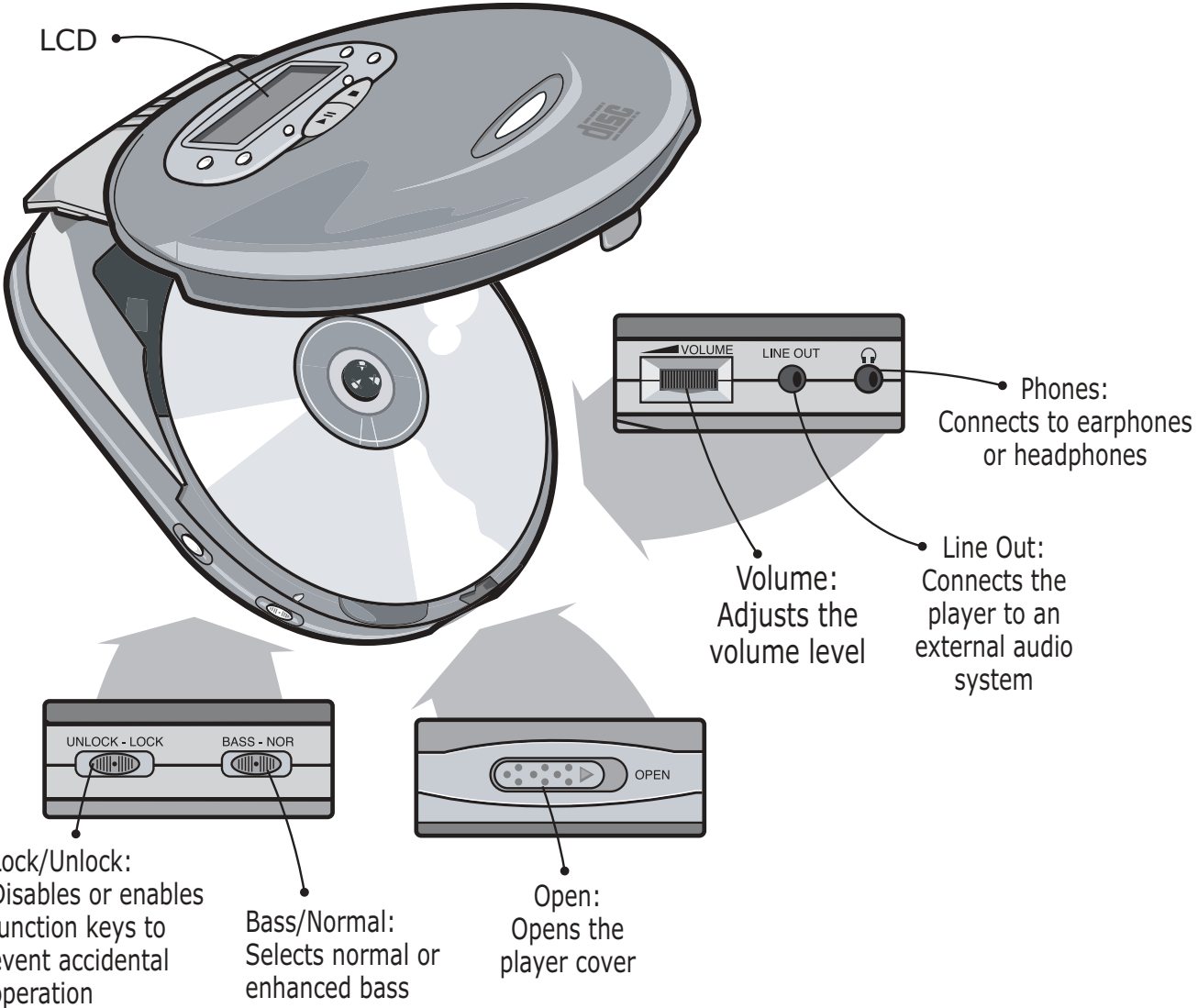



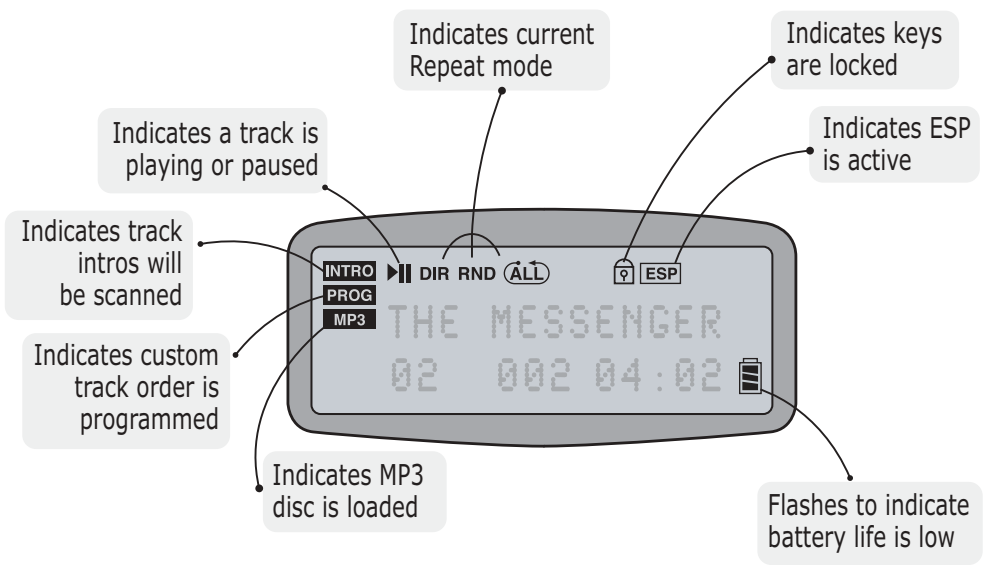
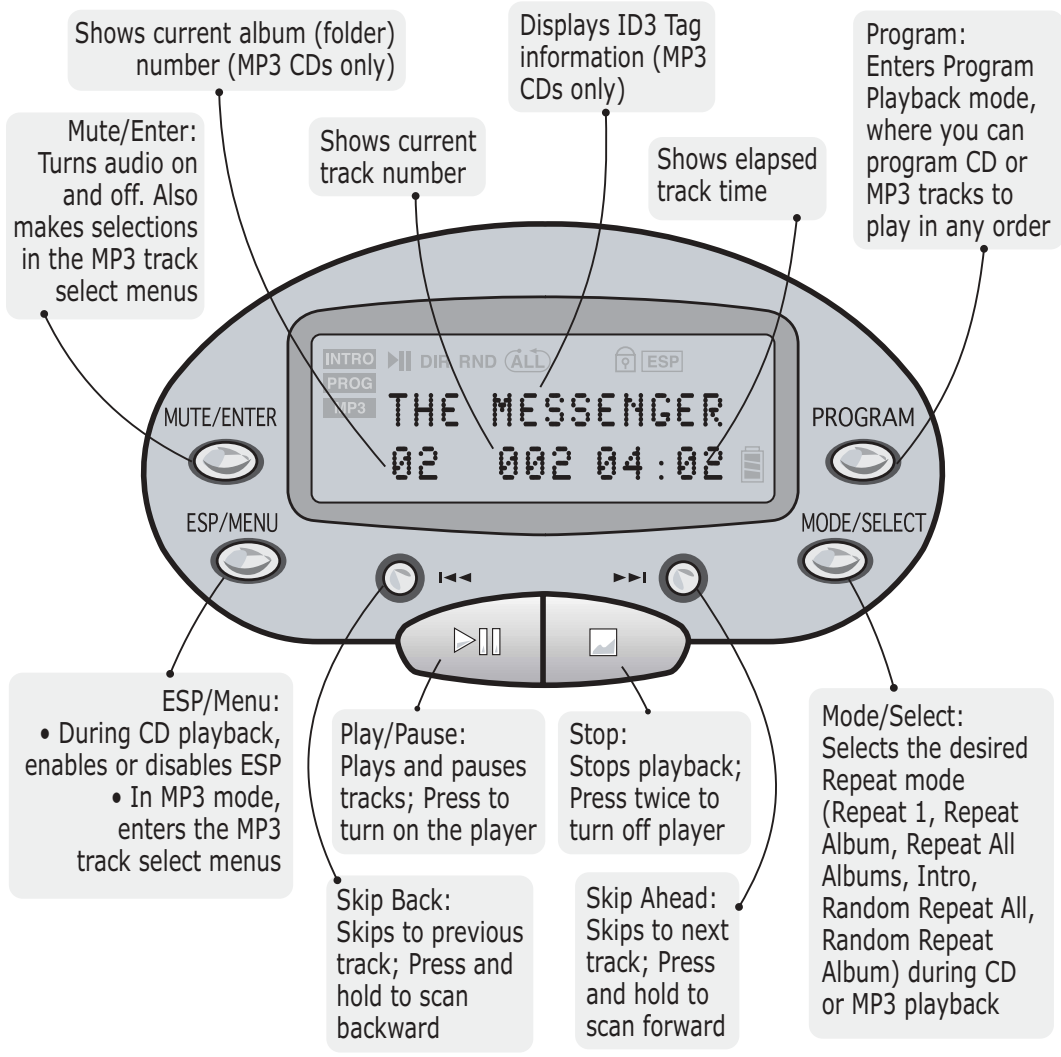

LCD Overview



Advanced Features

Repeat Modes

Press the MODE/SELECT button to set the player to one of the following Repeat modes:

- Repeat 1  - Repeats the currently selected track.
- Repeat Album (MP3 only) DIR  - Repeats all tracks in the currently selected album (folder).
- Repeat All DIR  - Repeats all tracks (CD) or all albums (MP3).
- Intro **INTRO** - Plays the first 10 seconds of every track.
- Random All RND - Plays all tracks in random order.
- Random Album DIR RND  - Plays all the tracks in the selected album in random order.

ESP (Electronic Shock Protection)

- During CD playback, press the ESP/MENU button to activate electronic shock protection. The player will continuously buffer 45 seconds of music to guard against skipping.
- During MP3 playback, the player automatically creates a 2-minute buffer to prevent skipping.

Advanced Features (Cont.)

Program Playback **PROG**

Program playback allows you to play CD or MP3 tracks in a preset order.

Tip: MP3 files play in the order they are written onto the CD-R. To ensure that tracks play in the order you want, try adding "01" ~ "99" before the file names before recording them onto CD-R.

1. Load an audio CD or MP3 CD, then press the PROGRAM button.
Note: If programming an audio CD, skip to step 3.
2. Press the SKIP BACK ◀◀ /SKIP AHEAD ▶▶ buttons to select the desired album (folder) number, then press PROGRAM.
3. Press the SKIP BACK ◀◀ /SKIP AHEAD ▶▶ buttons to select the desired track number, then press PROGRAM.
4. Repeat steps 2 and 3 to store up to 24 CD tracks or up to 64 MP3 tracks. The total number of programmed tracks is indicated as "P_#"
5. Press the PLAY/PAUSE ▶|| button to begin playback of your custom track order.
6. Press the STOP button twice or open the CD cover to exit program playback.

Special MP3 Features

Searching for MP3 Tracks Alphabetically

1. Press the ESP/MENU button once.
2. Use the PLAY/PAUSE ►|| , STOP ■ , SKIP BACK ◀◀ and SKIP AHEAD ▶▶ buttons to highlight the first letter of the MP3 file name you are searching for, then press MUTE/ENTER.
3. Press MODE/SELECT twice to view all tracks that begin with the desired letter.
Note: If no tracks begin with that letter, press ESP/MENU twice to exit.
4. Press the SKIP BACK ◀◀ and SKIP AHEAD ▶▶ buttons to browse the list of tracks.
5. Press MUTE/ENTER to play the selected track.



Browsing MP3 Tracks by Album

1. Press the ESP/MENU button **twice**.
2. Press the PLAY/PAUSE ►|| /STOP ■ buttons to select the desired album (folder).
3. Press the SKIP BACK ◀◀ or SKIP AHEAD ▶▶ button to enter the album.
4. Use the PLAY/PAUSE ►|| /STOP ■ buttons to select the desired track, then press MUTE/ENTER to play the selected track.



FAQs

Frequently Asked Questions

What MP3 bit rates are supported?

- The player supports bit rates up to 320 kbps. It does not support bit rates below 32 kbps. See table for details...

Sampling Frequency (KHz)	Sampling Bitrate (kbps)
44.1	32 - 320
32	32 - 112
22.05	16 - 80
16	16 - 48

Are ID3 tags supported?

- Yes, the player supports ID3 Tags in ASCII code. However, other code formats, including compressed format and Lyrics tag mode, are not supported.

Why does the player turn off when I plug in the AC adapter?

- As a safety precaution, the player will turn off when changing from battery to AC power. Simply press PLAY/PAUSE ►|| to restart the unit.

What CD-R formats can I use?

- The player supports CD-Rs burned in UDF/ISO9660 (Constant Package)/Joliet format.

How long will the batteries last?

- Two AA batteries typically provide up to 10 hours of continuous MP3 playback.

Why does the player stop when I press ESP/MENU?

- It is normal for the player to stop momentarily when you select ESP/MENU while an audio CD is playing. Turning off ESP clears the buffer and the player has to reload the data which had previously been stored in the buffer.

FAQs (cont.)

Which brand of CD-R/CD-RW is best?

- We do not have a “recommended list” of CD media, burners, software, etc. If you have a problem with a certain CD-R or CD-RW disc, try a different brand, and/or slow the burning speed down to 2x.

How does skip protection work?

- When the player starts, a buffer is filled with up to 2 minutes of track data. When the buffer is full, the CD will stop spinning and the tracks will play from memory, which helps to conserve battery life. When about 30 seconds remain in the buffer, the CD will again spin and refill the buffer. During this time, if the player is jarred so the buffer cannot be filled (for example, when jogging or riding a bicycle), then the player may begin to skip. You will need to let the buffer fill completely in order to have skip-free performance.

Technical Specifications

Power Source

- AC Adapter: Input 4.5V

Battery

- DC 3V (AA 1.5Vx2)

Earphone Output Power

- 10mW

Storage Media

- CD-DA, CD-R, CD-RW

Dimensions

- 4.7" (120mm) W x 5.9" (150mm) L x 1.1" (27mm) H

Weight

- 8 oz (225g)

Electronic Shock Protection (ESP)

- CD-DA: 45 sec
- CD-MP3: 120 sec

Features

- 1 bit D/A converter
- Digital filter 4 times over-sampling
- Program up to 24 selected music tracks
- Bass Boost

Customer Care

Technical Support

United States

<http://www.sonicblue.com>

Email: customersupport@sonicblue.com

Telephone: (541) 967-2450

Fax: (541) 967-2401

Customer Service

United States

<http://www.sonicblue.com>

Email: customersupport@sonicblue.com

Telephone: (800) 468-5846

Fax: (541) 967-2485

Web site

<http://www.sonicblue.com>

RioVolt SP50 Support

With every RioVolt SP50 you receive the following support services:

- Unlimited access to the Rio Web-based technical information resources, available 24 hours a day at <http://www.sonicblue.com>. Here you will find FAQ files, a knowledge base search engine, product updates and other useful tools.
- Unlimited email support for the duration of your warranty period.

Warranty

Our Warranty to You

- SONICblue Incorporated warrants that your product will be free from defects in materials and workmanship for a period of one year from the date of original retail purchase. If you discover a defect covered by this warranty, we will repair or replace the product at our option using new or remanufactured components. SONICblue Incorporated's liability is limited solely to the repair or replacement of the defective product. This warranty is extended to the original end user purchaser only and is not assignable or transferable to any other party. Any parts or boards removed in the replacement or remanufacture process shall become the property of SONICblue Incorporated.

How to Obtain Service Under this Warranty

- To obtain service under this warranty, please contact the dealer from whom you purchased the product or SONICblue Incorporated's Customer Care Center for return instructions.
- You must deliver the product and the original sales receipt to the dealer from whom you purchased this product or to SONICblue Incorporated in order to obtain service under this warranty. If you return the product to SONICblue Incorporated, you must pay for shipping to SONICblue Incorporated.

Our Mailing Address

SONICblue Incorporated
7835 East McClain Drive
Scottsdale, AZ 85260-1732 USA

- Items received without a valid return authorization number will be returned to sender.

Product Failures Not Covered by this Warranty

- This warranty covers defects in manufacture that arise from correct use of the device. It does not cover damage cause by abuse, misuse, improper modification or repair, moisture, extreme heat or cold, corrosive environments, shipping, or high voltage surges from external sources such as power line, telephone line, or connected equipment. This warranty does not cover wear and tear on covers, housing or wiring. This warranty also does not apply to any product with an altered or defaced serial number.

Limits of Liability

- We are only responsible for the repair of this product. We will not be liable to you or anyone else for any damages that result from the failure of this product or from the breach of any express or implied warranties. These include damage to other equipment, lost data, lost profits, or any consequential, incidental, or punitive damages. In no event will SONICblue Incorporated be liable for any amount greater than the currently suggested retail price of this product.
- This written warranty represents the entire warranty agreement between SONICblue Incorporated and you. This warranty is give in lieu of all other warranties, express or implied, including without limitation implied warranties of merchantability and fitness for a particular purpose. This warranty is limited to the term specified above. No warranties, either express or implied, will apply after this period. This warranty may not be altered in any way other than in writing by an officer of SONICblue Incorporated. This warranty gives you specific legal rights and you may also have other rights, which vary, from state to state. Some states limit what warranties may be excluded as well as how long an implied warranty lasts, so the above limitations may not apply to you.

Important Safety Information



WARNING

TO REDUCE THE CHANCE OF SHOCK OR INJURY, DO NOT USE OR OPERATE THIS DEVICE IN OR NEAR WATER OR WET LOCATIONS.



CAUTION

RISK OF EXPLOSION, DAMAGE OR BATTERY LEAKAGE IS POSSIBLE IF REPLACED INCORRECTLY OR BY AN INCORRECT TYPE. DISPOSE OF USED BATTERIES ACCORDING TO INSTRUCTIONS OR LOCAL LAWS.

Use only certified and approved Batteries and AC Adapters as those specified in the product User Guide.

Use of headphones while operating a vehicle is not recommended and is unlawful in some states and areas. Be careful and attentive while driving. Stop operation of the player if you find it disruptive or distracting while operating any type of equipment. Listening to music at full power over extended periods of time can be damaging to the hearing of the user.

Class 1 Laser

Invisible laser radiation when open and interlocks defeated, avoid exposure to beam.

NOTE: This equipment has been tested and found to comply with the limits for a Class B digital device, pursuant to Part 15 of the FCC Rules. These limits are designed to provide reasonable protection against harmful interference in a residential installation. This equipment generates, uses and can radiate radio frequency energy and, if not installed and used in accordance with the instructions, may cause harmful interference to radio communications. However, there is no guarantee that interference will not occur in a particular installation. If this equipment does cause harmful interference to radio or television reception, which can be determined by turning the equipment off and on, the user is encouraged to try to correct the interference by one or more of the following measures:

- Reorient or relocate the receiving antenna.
- Increase the separation between the equipment and receiver.
- Connect the equipment into an outlet on a circuit different from that to which the receiver is connected.
- Consult the dealer or an experienced radio/TV technician for help.

Copyright/Trademark

©2002 SONICblue, Incorporated. All rights reserved.

SONICblue, Incorporated does not assume any liability for errors or omissions in this document or make any commitment to update the information contained herein.

Rio™ is a registered trademark of RioPort, Inc. in the United States and/or other countries and is used under license. All other brand and product names are trademarks of their respective companies or organizations.





2481 Mission College Blvd.
Santa Clara, CA 95054-1838
www.sonicblue.com