

**AIPTEK®**

# POCKETDV 3100

**Installation Guide**

English



## Notice

1. Do not drop, puncture or disassemble the camera.

2. Remove batteries during long periods between use.

3. Avoid all contact with water and dry hands before using.

4. Do not expose the camera to high temperature or leave it in direct sunlight.

5. Avoid pressing hard on the camera body.



# Content

<b>Identifying your camera parts</b>	<b>2</b>	<b>Copying Pictures to Your Computer</b>	<b>15</b>
<b>Preparing Your Camera</b>	<b>3</b>	1.Installing the driver and application	
Installing batteries		2.Connecting your camera to your computer	
Inserting CF card (Optional)		3.Copying pictures to your computer	
Attaching strap (Optional)		4.Viewing pictures on your computer	
Using tripod (Optional)			
How to hold your camera		<b>Using PC Camera (Video Conferencing) Function</b>	<b>22</b>
<b>Using Your Camera</b>	<b>5</b>	1.Installing the driver and application	
Turning on/off your camera		2.Connecting your camera to your computer	
Recording AVI movies		3.Open PC Camera (Video Conferencing) interface	
Taking pictures		4.Using your PC Camera	
Playback		<b>Additional Information</b>	<b>29</b>
Deleting a single picture		Battery indication and reduce power consumption	
Voice recording		Storage capacity	
Self-Timer		Tips for best shoot	
Setting		Language reference table	
		Troubleshooting	
		Specification	
<b>Exporting to TV</b>	<b>13</b>	<b>AIPTEK Service</b>	<b>37</b>
1.Connecting your camera to your TV			
2.Previewing and playback on TV			

## Identifying your camera parts

- 1** Shutter button
- 2** Record button
- 3** Up button
- 4** Down button
- 5** MENU/OK button (Power button)
- 6** USB port
- 7** AV-out port
- 8** CF Card slot
- 9** Eject ( CF Card)
- 10** LED light
- 11** LCD display
- 12** View finder
- 13** LCD on/ off button
- 14** Strap-holder
- 15** Focus
- 16** Lens
- 17** Microphone
- 18** Mirror
- 19** Tripod port
- 20** Battery cover
- 21** Speaker

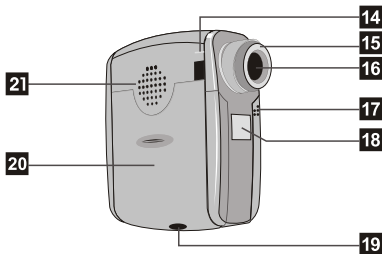
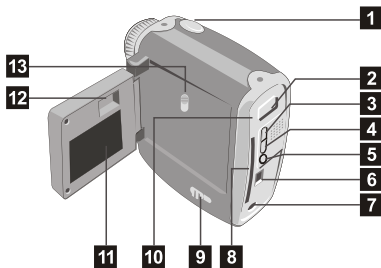

## Preparing Your Camera

### Installing Batteries

Your camera runs on two AA alkaline batteries. High performance batteries are recommended for this camera for maximum battery life.

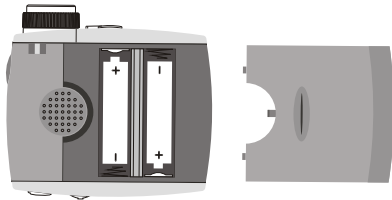

### Inserting CF card (Optional)

In addition to 16MB (128Mbits) built-in flash memory, your camera can store data on Compact Flash Card (8MB-512MB). Insert your CF Card as shown. Files will be automatically stored on the CF Card after you've inserted the CF Card.

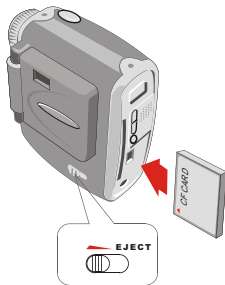

Do not eject CF Card while the camera is processing data.

## Attaching strap (Optional)

Attach the carrying strap for convenience and safety.

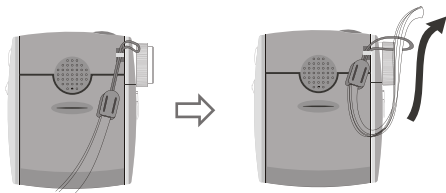

## How to hold your camera

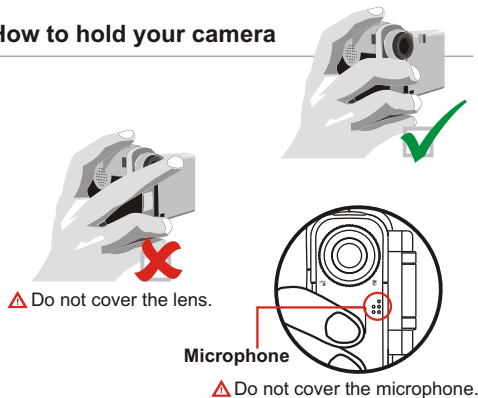

## Using tripod (Optional)

Use a tripod to minimize camera movement and ensure optimal image quality, especially while shooting longer movies, self-portraits or video conferencing.

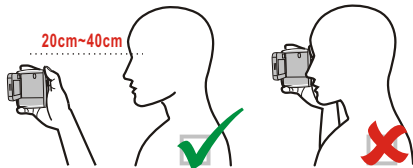

## Using Your Camera

### Turning on your camera

Follow either of the two methods to turn on your camera.

#### 1 Opening LCD panel

Open the LCD panel. The LCD display and camera will be turned on. Be careful not to over extend the panel.

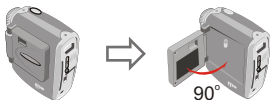

#### 2 Using MENU/OK button

Press and hold the **MENU/OK** button for 3 seconds to turn on your camera.

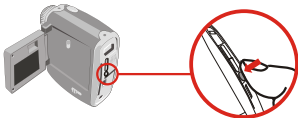

### Turning off your camera

Follow either of the two methods to turn off your camera.

- 1 Snap the LCD panel to the camera body and the camera will be turned off.

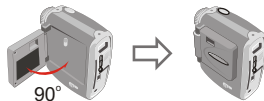

- 2 Press the **MENU/OK** button for 3 seconds.

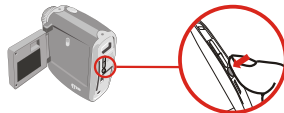

Your camera will automatically shut off after 60 seconds of inactivity. To turn on your camera, press the **MENU/OK** button for 3 seconds.

## Recording AVI movies

- (1) Press and release the **Record** button to record.
- (2) Flashing LED light indicates recording in progress.
- (3) Press and release the **Record** button again to stop recording.

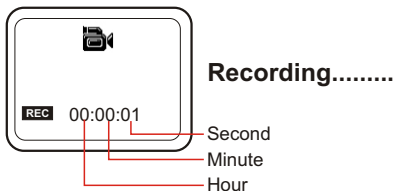
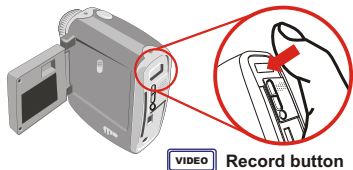

## Taking Pictures

### 1 Set focus

Set focus before taking pictures.

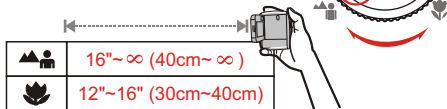

### 2 Zoom In/ Zoom Out

Zoom in: Press the **Up** button up to zoom in image.

Zoom out: Press the **Down** button down to zoom out.

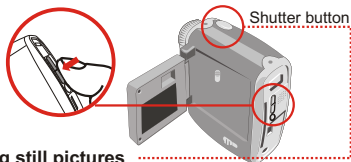

### 3 Taking still pictures

(1) Press the **Shutter** button.

(2) After LED light stops, image is successfully captured.



## Playback

### 1 Entering MENU

Press and release the **MENU/OK** button to show MENU.

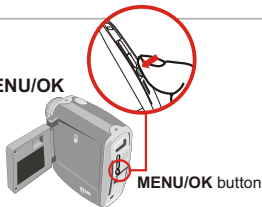

MENU/OK button

### 2 Selecting mode

Press the **Up** or **Down** button to highlight . Then press the **MENU/OK** button again to select Playback mode.

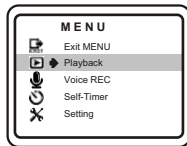
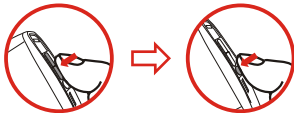

### 3 Selecting a thumbnail

After selecting Playback mode, you enter thumbnail mode. Press the **Up** or **Down** button to shift between thumbnails.

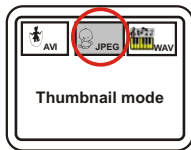

Thumbnail mode

### 4 Playing back the file

Press the **MENU/OK** button to playback files.

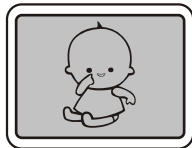

Full Screen

### 5 Stopping playback

Press the **MENU/OK** button again to stop playback and return to thumbnail mode.



If you want to play another files, please repeat the steps from **3** to **5**. Or stay at step **4**, and press the **Up** button to playback the previous file or press the **Down** button to playback the next file.

### 6 Returning to preview mode

To return to LCD preview mode from thumbnail mode, press the **Record** button.



VIDEO Record button

## Deleting a single picture

In Playback mode (see Playback section for details), you can delete a single file.

### Situation 1 : When you are in thumbnail mode

**1** Select a *thumbnail*.

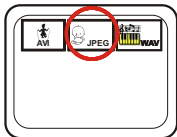

Thumbnail mode

**2** Press the **Shutter** button.



**3** Show *recycle bin*.

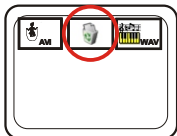

**4** Press the **Shutter** button again and the file will be erased.



If you don't press the **Shutter** button again within 5 seconds, the camera will return to step **1** and delete nothing.

### Situation 2 : When you are in full screen mode

**1** Playback in full screen.

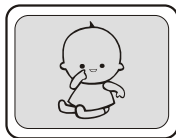

Full Screen mode

**2** Press the **Shutter** button.



**3** Show *recycle bin*.



**4** Press the **Shutter** button again and the file will be erased.



If you don't press the **Shutter** button again within 5 seconds, the camera will return to step **1** and delete nothing.

## Voice Recording

### 1 Entering MENU

Press and release the **MENU/OK** button to show MENU.

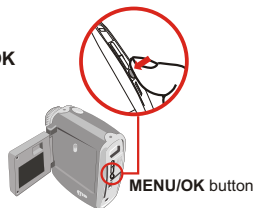

(2) LED light indicates voice is being recorded.

(3) Speak directly into the microphone.

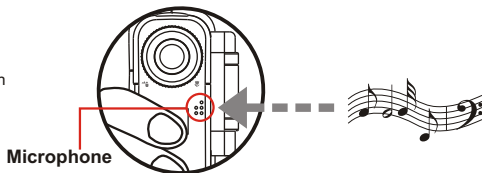

### 2 Voice recording

(1) Press the **Up** or **Down** button to highlight  and press the **MENU/OK** button to start voice recording.

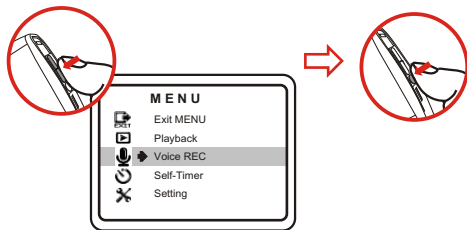

(4) Press the **MENU/OK** button to stop voice recording.

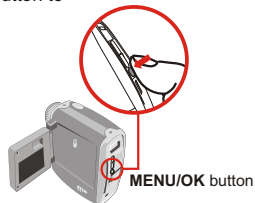

## Self Timer

### 1 Entering MENU

Press and release the **MENU/OK** button to show MENU.

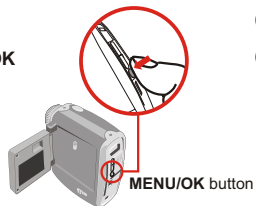

(3) Press the **Shutter** button.

(4) Counter will count down from ten to zero and take the picture.

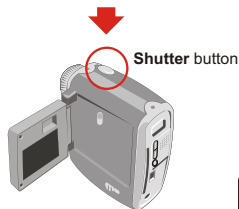

### 2 Self-Timer

(1) Press the **Up** or **Down** button to highlight .

(2) Press the **MENU/OK** button to select .

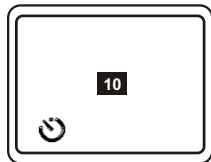
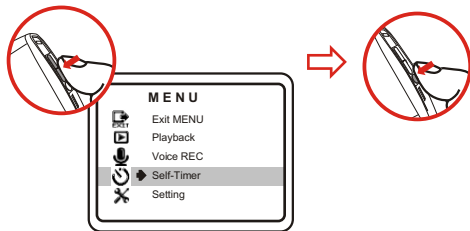

## Setting

### 1 Entering MENU

Press and release the **MENU/OK** button to show MENU.

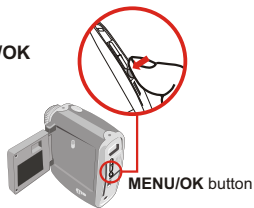

### 2 Selecting mode

Press the **Up** or **Down** button to highlight .

Then press the **MENU/OK** button again to select Setting mode.

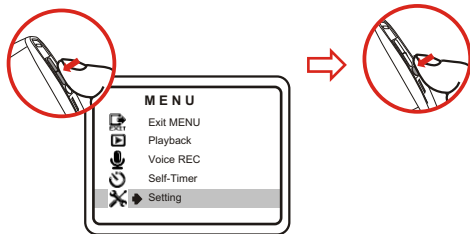

### 3 Changing the Setting

Press the **Up** or **Down** button to shift between modes.

Then press the **MENU/OK** button to select mode.

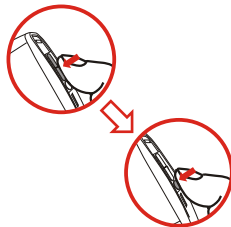

#### Setting Mode ( Page 1)

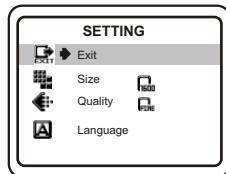

#### Setting Mode ( Page 2)

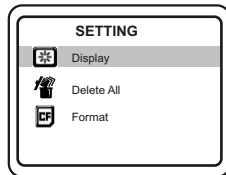

## The description for Setting item

Item	Setting	Description
<b>SIZE</b>	<b>2048x1536</b>	Larger size indicates clearer image. Select 2048x1536 or 1600x1200 when you want to develop 4x6 photo size. And select 1280x1024 to develop 3x5 photo size.
	<b>1600x1200</b>	
	<b>1280x1024</b>	
<b>QUALITY</b>	<b>Fine</b>	Select Fine, if you want to develop pictures.
	<b>Standard</b>	Select Standard, if you only need to view pictures on PC.
<b>LANGUAGE</b>	<b>ENGLISH</b>	Multi-lingual LCD supports English and German. See the <b>Language Reference Table</b> section for French, Italian, Spanish, Netherlands and Portuguese language reference.
	<b>DEUTSCH</b>	
<b>DISPLAY</b>	<b>ON</b>	Turn on/ off the status shown on the LCD.
	<b>OFF</b>	
<b>DELETE ALL</b>	<b>NO</b>	Delete all still pictures, AVI movies and audio files from your camera.
	<b>YES</b>	
<b>FORMAT</b>	<b>NO</b>	Format the memory of CF Card and clear all data from the memory.
	<b>YES</b>	

## Exporting to TV

### Connecting your camera to your TV

Connect your camera and TV via A/V out cable for real time display. You can export your video, still pictures and audio directly to your TV or VCR to share them with friends and family.

- 1 Turn on your TV and select AV-in mode.
- 2 Please plug in Video and Audio AV cable to your TV.
- 3 Plug in the camera.
- 4 Turn on the camera.

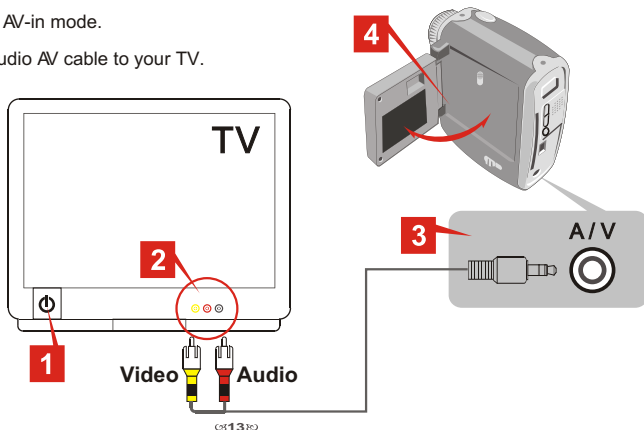

## Previewing and playback on TV

With few steps, you can take pictures, record AVI Movies and playback files on TV.

More functions are available when images export to TV. For more details, please see the *Using Your Camera* section.

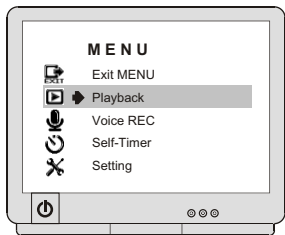

Press the **MENU/OK** button to enter MENU. Then select Playback mode to playback image.

Press the **Shutter** button to take a still picture

Press the **Record** button to take AVI Movies. Then Press it again to stop recording.



## Copying pictures to your computer

### 1 Installing the driver and application

You need to install DV 3100 Driver before your camera connects to your computer at the first time. Please follow the steps to complete the installation.

※ MS XP users can skip this step **1** and go to step **2** directly if you don't use PC Camera function.

- 1 Turn on your computer.
  - ※ Do not connect your USB Cable to your computer in this step.
  - ※ Turn off the application programs running on your computer.

- 2 Place the accessory CD into the CD-ROM drive.

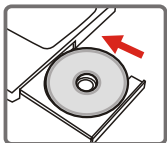

The title appears in a few seconds.

### If no title appears on screen

- 1 Double-click the icon "My computer".
- 2 Double-click the icon CD-ROM ("DV3100 (E:)")
  - \*The CD-ROM driver varies, depending on how your computer is set up.

- 3 Move the cursor to "DV 3100 Driver" and click on it.



- 4 The "Install Shield Wizard" appears and automatically installs the program. When Fig 1 appears, please click "Next".

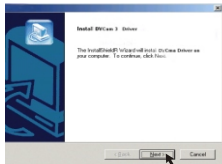

Fig 1

- 5 When Fig 2 appears, please click "Yes" or "No" according to your circumstance:

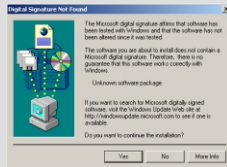

Fig 2

1. If you are not a Windows XP user and never install DirectX 8.0 or above, please click "Yes".
2. If you are a Windows XP user or you have already installed DirectX 8.0 or above, please click "No".

## Notice for Windows 2000 users

1. The checkbox "Digital Signature Not Found" might appear twice, please simply click "Yes". This camera works perfectly for Windows 2000 operation system.



2. Then, follow the on-screen instructions and click "Finish".

✳ Don't restart your computer in this step.

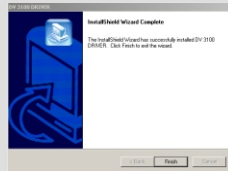

- 6 When Fig 3 or Fig 4 appears, please click "Finish" or "OK" to complete the program installation.



Fig 3



Fig 4

- ☞ The driver is available for use after your computer is restarted.

- 7 Remove the CD from the CD-ROM driver.

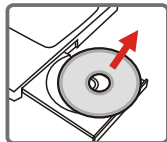

## 2 Connecting your camera to computer

1. Turn on your computer.
2. Connect the USB cable to the USB port of the computer.

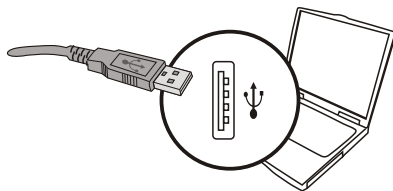

3. Connect the other end of the USB cable to your camera.

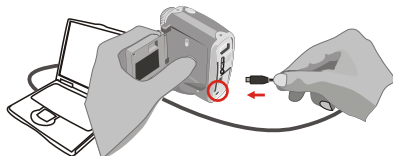

### 3 Copying pictures to your computer

#### Windows XP users

- 1 After your camera is connected to your computer, Fig 5 will appear automatically. Please select **"Open folder to view files using Windows Explorer"** item and click **"OK"**.

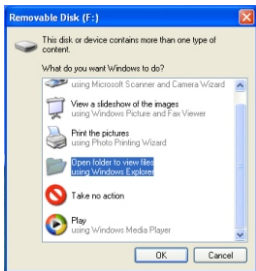

Fig 5

#### Windows 2000/ME/98SE users

- 1 Double-click the icon **"My Computer"**



Then double-click the icon **"Removable Disk"** to identify the new drive.

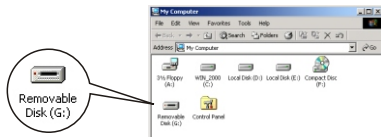

② Double-click "DCIM" file folder.

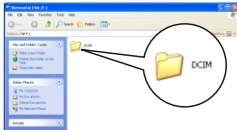

Windows XP

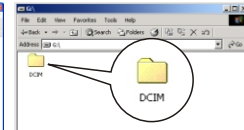

Windows 2000/ME/98 SE

③ Double-click "100MEDIA" file folder.

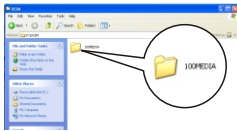

Windows XP

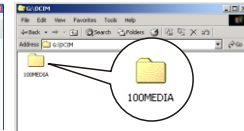

Windows 2000/ME/98 SE

④ Drag the picture to "My Documents" file folder.

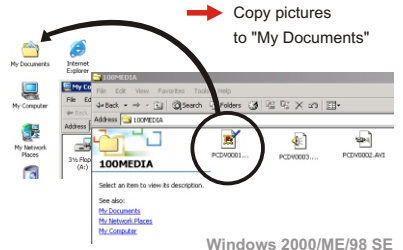
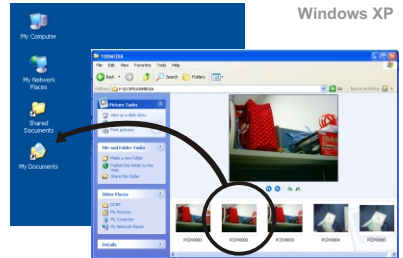

## 👉 Picture's positions

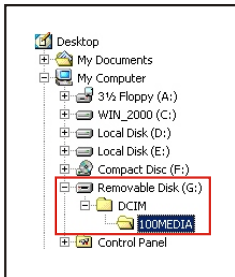

## 4 Viewing pictures on your computer

### 1 Double-click "My Documents"

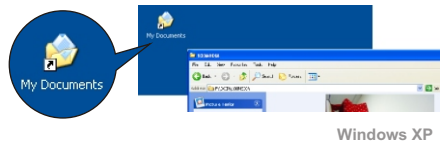

Windows XP



Windows 2000/ME/98 SE

2 Double-click the desired file.

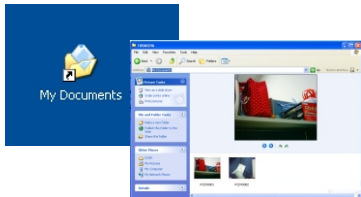

Windows XP



My Documents

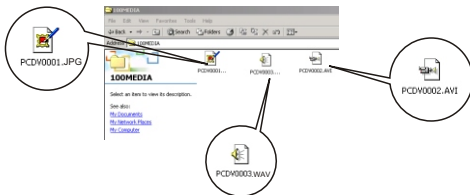

Windows 2000/ME/98 SE

**Notice for Windows 2000/ME users:**

Before you disconnect your camera and computer, please follow the steps below:

1. Double click  on the system-tray.
2. Click  (**USB Disk**), then click "Stop"
3. Confirm the device (DV 3100) on the confirmation screen and click **"OK"**.
4. Follow the instructions shown on the screen to remove your camera from your computer safely.

## Using PC Camera (Video Conferencing) Function

### 1 Installing the driver and application

You need to install DV 3100 Driver before using PC Camera or Video Conferencing function.

If you have already installed DV 3100 Driver, please skip this step **1** and go to step **2** directly.

If you never install DV 3100 Driver, please finish the installation first. (For its details, please see the step **1** in the *Copy Pictures to Your Computer* section)

### 2 Connecting your camera to your computer

1. Turn on your computer.
2. Connect the USB cable to the USB port of the computer.

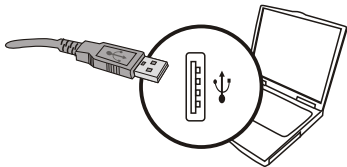

3. Connect the other end of the USB cable to camera.

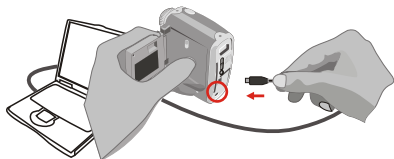

4. Press the **Up** or **Down** button to highlight **PC** and press the **MENU/OK** button to select.

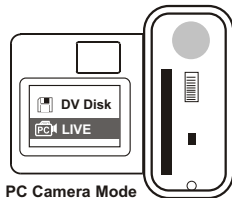
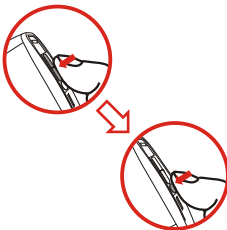



**Notice:**

When you use PC Camera (Video Conferencing) function at the first time, please follow the step below.

**Windows 2000**

The checkbox **"Digital Signature Not Found"** might appear twice, please simply click **"Yes"**. This camera works perfectly for MS Windows 2000 operation system.

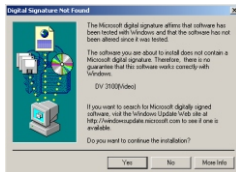
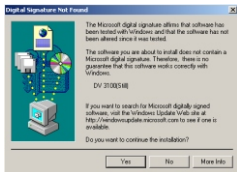
**Windows ME**

Please select **"Automatic search for a better driver"** when Fig 6 appears.



Fig 6

**Windows 98SE**

1. Click **"Next"** when Fig 7 appears.
2. Please select **"Automatic search for a best driver"** and click **"Next"** when Fig 8 appears.
3. Select the position where your 98SE driver is. Some users might be asked to insert licensed 98SE CD into the CD-ROM drive.
4. Follow the instructions shown on screen to finish installing the software that your new hardware device (camera) requires.



Fig 7

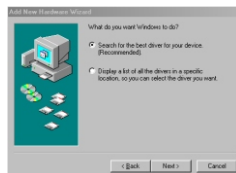

Fig 8

### 3 Open PC Camera (Video Conferencing) interface

Double-click the "DV 3100 ( PC Camera )" icon on the Desktop to execute the program to begin using your camera.



Click on the "Start" menu and go up to "Programs". Then go to the folder named "DV 3100 ( PC Camera )" and select it.

OR

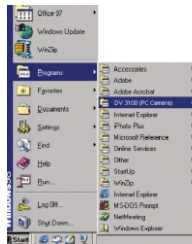

If you want to use Video Conferencing function

- 1 Install the NetMeeting software included with the accessory CD.
- 2 Launch the NetMeeting program to take advantage of the Video Conferencing function..

## 4 Using your PC Camera

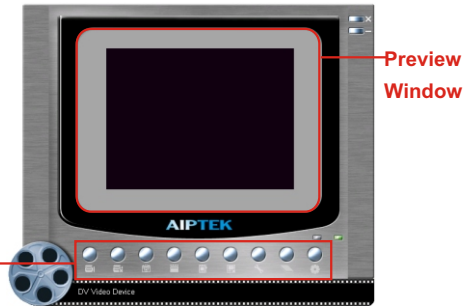
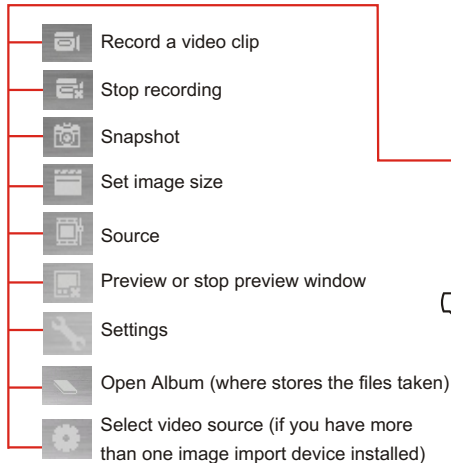

### Viewing pictures taken by PC Camera

- Click  to open Album. **Or**
- Files taken are stored in Work Temp. Please follow the path to find the files.

C:\Program Files \DV 3100 (PC Camera) \Work Temp

## Advanced Settings in PC Camera



### Set Image Size

#### ● Color Space

Select one of the following functions when you have different needs.

- RGB 24: better image quality
- I420: faster speed

#### ● Output Size

Setting output size can change the size of the preview window. The default size is 320x240. Choose larger pixels when you need a larger preview window.

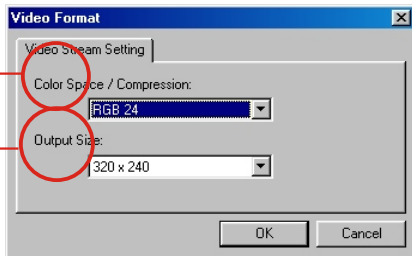

160 x 120  
176 x 144  
320 x 240  
352 x 288  
640 x 480



## Set Source

### ● Video Setting

#### - Banding Filter:

Using PC Camera function and your PC screen flickers, please change the banding filter in Video Setting. The refresh rate (the number of times the screen is redrawn per second) is the most likely cause of flicker. Select 50Hz or 60Hz until your PC screen stops flickering.

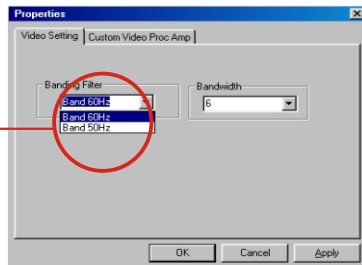

### ● Custom Video Pro Amp

You can use the default setting or change settings

( brightness, contrast, saturation, sharpness, and hue )

on your own.

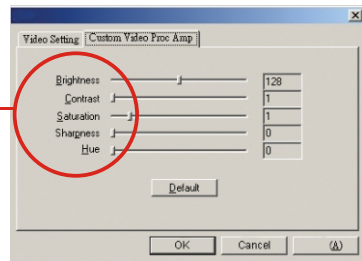



## Set Settings

Your camera has default flicker settings, which is country specific. If you use your camera abroad, please refer to the table below and check if the flicker settings of the country you intend to go match the flicker settings of your country or not. If it does not match, please select "Cancel Flicker" in the setting dialog to prevent pictures from appearing unnatural flickering noise.

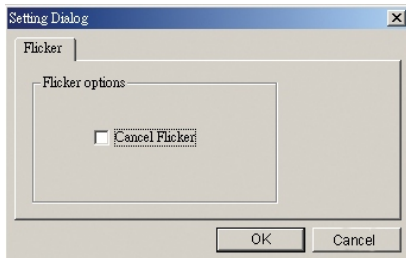

<b>Country</b>	England	Germany	France	Italy	Spain	Netherlands
<b>Setting</b>	50Hz	50Hz	60Hz	50Hz	50Hz	50Hz
<b>Country</b>	Portugal	America	Taiwan	China	Japan	Korea
<b>Setting</b>	50Hz	60Hz	60Hz	50Hz	50/ 60Hz	60Hz

## Battery indication and reduce power consumption

### Battery Indicators

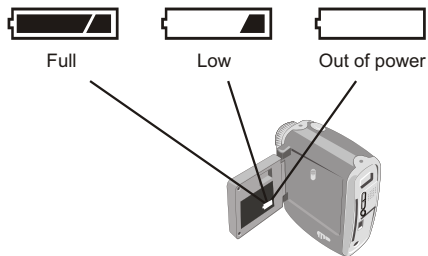

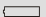
-  on the LCD display indicates out of power.

- When not using your camera for extended periods, we suggest you remove the batteries.

### LCD Backlight

To reduce power consumption, turn off the LCD backlight.

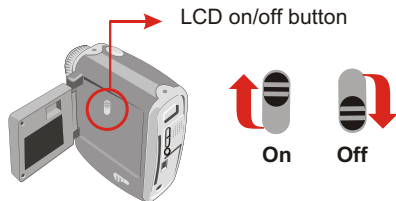

## Storage Capacity

The number of pictures, video and audio recording time is different, depends on the capacity of the internal memory or CF Card.

### AVI Movies

Memory	Estimated maximum recording time
16MB (Internal Memory/ CF Card)	About 2.5~4 min
32MB (CF Card)	About 5~8 min
64MB (CF Card)	About 10~16 min

### Voice Recording

Memory	Estimated Voice Recording Time
16MB	About 1 hour
32MB (CF Card)	About 2 hours
64MB (CF Card)	About 4 hours

### Still

Size	2048x1536 pixels		1600x1200 pixels		1280x1024 pixels	
	Quality					
	Fine	Standard	Fine	Standard	Fine	Standard
16MB (Internal Memory/CF Card)	About 15 pictures	About 30 pictures	About 20 pictures	About 40 pictures	About 30 pictures	About 60 pictures
32MB (CF Card)	About 30 pictures	About 60 pictures	About 40 pictures	About 80 pictures	About 60 pictures	About 120 pictures
64MB (CF Card)	About 60 pictures	About 120 pictures	About 80 pictures	About 160 pictures	About 120 pictures	About 240 pictures

**Note** This table is for your reference. Actual number of pictures stored may vary (up to  $\pm 30\%$ ) depending on resolution and color saturation.



## Tips for best shoot

- 1 Keep the focus set to  except for extreme close-ups.
- 2 Make sure your subject is well lit from the front.
- 3 Keep the camera level and steady when releasing the shutter.
- 4 Make sure you have adequate light when taking still pictures or movies.
- 5 For best quality video, move the camera slowly during filming.

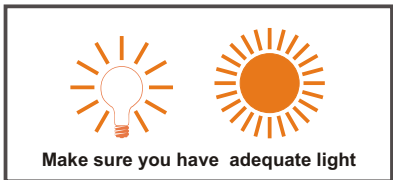
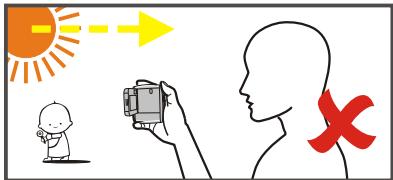
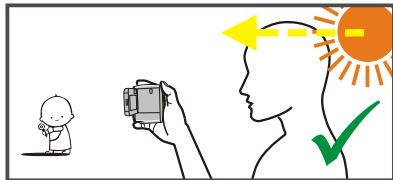

## Language Reference Table

	EN	GE	IT	DU	PT	SP	FR
1	Exit MENU	MENÜ <u>beenden</u>	Uscita MENU	Menu <u>afsluiten</u>	MENU <u>Sair</u>	MENÚ Salir	Quitter le MENU
2	Play	<u>Wiedergabe</u>	Esecuzione	<u>Afspelen</u>	<u>Reproduzir</u>	Reproducir	Lecture
3	Voice REC	Tonaufzeichnung	Reg. vocale	<u>Geluidsofname</u>	Gravação de Voz	Grab.de voz	Enreg.Vocal
4	Self-Timer	<u>Selbstausslöser</u>	Autoscatto	<u>Zelfontspanner</u>	Temp. Auto.	Temp. auto.	Retardateur
5	Setting	<u>Einstellung</u>	Impostazione	Installing	Definições	Configuración	Paramétrage
5-1	Exit	<u>Beenden</u>	Esci	<u>Afsluiten</u>	<u>Sair</u>	Salir	Quitter
5-2	Size	<u>Größe</u>	Dimensioni	<u>Grootte</u>	<u>Tamanho</u>	Tamaño	Taille
5-2-1	Size 2048 x 1536 1600 x 1200 1280 x 1024	<u>Größe</u> 2048 x 1536 1600 x 1200 1280 x 1024	Dimensioni 2048 x 1536 1600 x 1200 1280 x 1024	<u>Grootte</u> 2048 x 1536 1600 x 1200 1280 x 1024	<u>Tamanho</u> 2048 x 1536 1600 x 1200 1280 x 1024	Tamaño 2048 x 1536 1600 x 1200 1280 x 1024	Taille 2048 x 1536 1600 x 1200 1280 x 1024
5-3	Quality	<u>Qualität</u>	Qualità	<u>Kwaliteit</u>	<u>Qualidade</u>	Calidad	Qualité
5-3-1	Quality Fine Standard	<u>Qualität</u> Fein Standard	Qualità Fine Standard	<u>Kwaliteit</u> Fijn Standaard	<u>Qualidade</u> Fina Normal	Calidad Fina Estándar	Qualité Fine Standard
5-4	A/V out	A/V-Ausgang	Uscita A/V	A/V <u>uitgang</u>	A/V out	Salida A/V	Sortie A/V
5-4-1	A/V out PAL NTSC	A/V-Ausgang PAL NTSC	Uscita A/V PAL NTSC	A/V <u>uitgang</u> PAL NTSC	A/V out PAL NTSC	Salida A/V PAL NTSC	Sortie TV PAL NTSC
5-5	Language	<u>Sprach</u>	Lingua	<u>Taal</u>	<u>Idioma</u>	Idioma	Langue

	EN	GE	IT	DU	PT	SP	FR
<b>5-5-1</b>	Language English Deutsch Français Italiano Español  Netherlands Português	<u>Sprach</u> English Deutsch <u>Français</u> <u>Italiano</u> <u>Español</u> Netherlands <u>Português</u>	Lingua English Deutsch Français Italiano Español Netherlands Português	<u>Taal</u> English Deutsch <u>Français</u> <u>Italiano</u> <u>Español</u> <u>Nederlands</u> <u>Português</u>	Idioma Inglês Alemão Francês Italiano Castelhano Holandês Português	Idioma English Deutsch Français Italiano Español Netherlands Português	Langue English Deutsch Français Italiano Español Netherlands Português
<b>5-6</b>	Display	<u>Anzeige</u>	Schemo	<u>weergave</u>	Indicações	Pantalla	Affichage
<b>5-6-1</b>	<u>Display</u> ON OFF	<u>Anzeige</u> EIN AUS	Schemo Attivo Disattivo	<u>weergave</u> <u>Aan</u> <u>Uit</u>	<u>Indicações</u> ON OFF	Pantalla ENCENDER (ON) APAGAR (OFF)	Affichage Activé Désactivé
<b>5-7</b>	Delete All	<u>Alles löschen</u>	Elimina tutto	<u>Alles wissen</u>	<u>Eliminar Todos</u>	Eliminar todo	Supprimer tout
<b>5-7-1</b>	Are you sure? Yes No	<u>Sind Sie sicher?</u> Ja Nein	Tutti i file saranno eliminati. Si è sicuri? Sì No	<u>Alle bestanden</u> <u>worden gewist.</u> <u>Weet u het</u> <u>zeker?</u> <u>Ja</u> <u>Nee</u>	Todos os ficheiros serão eliminados. Tem a certeza? <u>Sim</u> <u>Não</u>	Se eliminarán todos los archivos. ¿Está seguro? Sí No	Tous les fichiers seront supprimés. Etes-vous sûr? Oui Non

	EN	GE	IT	DU	PT	SP	FR
<b>5-7-1-1</b>	Deleting...	Wird gelöscht...	Eliminazione in corso...	Verwijderen...	A eliminar...	Eliminando...	Suppression en cours...
<b>5-7-1-1-1</b>	All files have been deleted.	Alle Dateien wurden gelöscht.	Tutti i file sono stati eliminati.	Alle bestanden zijn verwijderd.	Todos os ficheiros foram eliminados.	Se han eliminado todos los archivos.	Tous les fichiers ont été supprimés.
<b>5-8</b>	Format CF Card	CF-Karte formatieren	Formatta scheda CF	CF-kaart formatteren	Formatar cartão CF	Formatear tarjeta CF	Formater la carte CF
<b>5-8-1</b>	Format CF Card All files in CF Card will be deleted. Are you sure? Yes No	Sollen alle Dateien auf der CF-Karte wirklich gelöscht werden? Ja Nein	Tutti i file della scheda CF saranno eliminati. Si è sicuri? Sì No	Alle bestanden op de CF-kaart worden verwijderd. Weet u het zeker? Ja Nee	Todos os ficheiros no cartão CF serão eliminados. Tem a certeza? Sim Não	Se eliminarán todos los archivos de la tarjeta CF. ¿Está seguro? Sí No	Tous les fichiers dans la carte CF seront supprimés. Etes-vous sûr? Oui Non
<b>5-8-1-1</b>	Formatting CF Card...	Die CF-Karte wird formatiert...	Formattazione scheda CF in corso ...	CF-kaart formatteren...	A formatar Cartão CF...	Formateando tarjeta CF...	Formatage Carte CF en cours ...
<b>5-8-1-1-1</b>	CF Card has been formatted.	Die CF-Karte wurde formatiert.	La scheda CF è stata formattata.	CF-kaart is geformateerd.	O Cartão CF foi formatado.	Se ha formateado la tarjeta CF.	La carte CF a été formatée.
<b>Reset</b>	Please wait.	Bitte warten.	Attendere.	Even wachten.	Aguarde.	Espere, por favor.	Veuillez patienter.

## Troubleshooting

### Symptom

### Actions

Cannot turn on your camera.

- Press the MENU control for 3 seconds.
- Change new batteries.

Can't take pictures, record or voice record.

- Memory is full. Please transfer data to PC.

TV doesn't show TV preview after AV-out cable is connected.

- Change AV-out port. Insert white cable to audio port and yellow one to video port.

Images are blurred.

- Adjust the focus.

Images are too dark.

- Take pictures while there is adequate light.
- Use editing tools such as PhotoExpress to adjust image brightness.

## Specifications

---

**1.5" Color TFT LCD for previewing and playing back**

**Digital Zoom:** 2x

**Auto Exposure & Auto White Balance**

**Self Timer:** 10 second

**Power Saving:** Auto power off if idle over 60 seconds

**Built-in Microphone & Speaker**

**Battery:** AA x 2 (Alkaline recommended)

**Dimension:** 3.3" x 3.1" x 1.6" (L x H x W)

---

- **Hardware Resolution** / 2048x1536 (3.1 Mega) pixels
  - **Sensor Effective Resolution** / 1600x1200 (2 Mega) pixels
  - **Internal Memory** / Built-in 16 MB Flash memory (Storage);  
16 MB SDRAM (Buffer)
  - **External Memory** / Built-in Compact Flash Card slot  
(Maximum: 512 MB)
- 

## Main Functions

- **Digital Video Camcorder:**

QVGA (320 x 240 pixels) / up to 10 fps

- **Digital Still Camera:**

2048x1536 (3.1 Mega) pixels

1600x1200 (2 Mega) pixels

1280x1024 (1.3 Mega) pixels

- **Digital Voice Recorder:**

Up to 1 hour while using internal 16MB flash memory

- **Video Conferencing:**

VGA 640x480 pixels ) / up to 10fps

QVGA 320x240 pixels ) / up to 24fps

- **Supports AV output**

---

---

## AIPTEK Service

---

If you have any problems, please contact AIPTEK office to which your country is assigned. Please note: If you reside outside of the United States or Germany, please contact AIPTEK Intl Inc.

---

### **AIPTEK, Inc.**

51 Discovery, Suite 100

Irvine, CA 92618, USA

TEL: 949-585-9600

FAX: 949-585-9345

<http://www.aiptek.com>

Online registration website:

<http://www.aiptek.com/registration/registration.htm>

( Online registration entitles you to special services, downloads and promotions. )

---

### **AIPTEK International GmbH**

Halskestrasse 6

47877 Willich, Germany

TEL +49 21 54 - 92 35 50

Fax +49 21 54 - 92 35 68

<http://www.aiptek.de>

---

### **AIPTEK International Inc.**

No. 5-1 Innovation Road I

Science-Based Industrial Park

Hsin-Chu 300

Taiwan, R.O.C.

Tel: 886-3-5678138

Fax: 886-3-5678569

<http://www.aiptek.com.tw>

---

