

 **FUJIFILM**

digital
Tools for the imagination.

DIGITAL CAMERA

FinePix 2600 Zoom

2.0
MEGA
PIXELS

3x
OPTICAL
ZOOM



Getting Ready

1

Basic Photography

2

Advanced Features
Photography

3

Advanced Features
Playback

4

Settings

5

PC Connection

6

OWNER'S MANUAL

This manual will show you how to use your FUJIFILM DIGITAL CAMERA FinePix2600 ZOOM correctly. Please follow the instructions carefully.

BL00022-200 (1)



Warning

To prevent fire or shock hazard, do not expose the unit to rain or moisture.

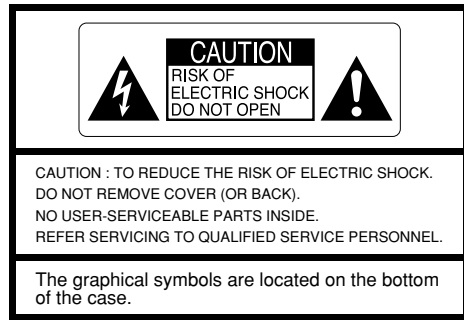

This symbol is intended to alert the user to the presence of uninsulated “dangerous voltage” within the product’s enclosure that may be of sufficient magnitude to constitute a risk of electric shock to persons.



This symbol is intended to alert the user to the presence of important operating and maintenance (servicing) instructions in the literature accompanying the appliance.

For customers in the U.S.A.

FCC Statement

This device complies with part 15 of the FCC Rules. Operation is subject to the following two conditions : (1) This device may not cause harmful interference, and (2) this device must accept any interference received, including interference that may cause undesired operation.

CAUTION

This equipment has been tested and found to comply with the limits for a Class B digital device, pursuant to Part 15 of the FCC Rules. These limits are designed to provide reasonable protection against harmful interference in a residential installation. This equipment generates, uses, and can radiate radio frequency energy and, if not installed and used in accordance with the instructions, may cause harmful interference to radio communications. However, there is no guarantee that interference will not occur in a particular installation. If this equipment does cause harmful interference to radio or television reception, which can be determined by turning the equipment off and on, the user is encouraged to try to correct the interference by one or more of the following measures :

- Reorient or relocate the receiving antenna.
- Increase the separation between the equipment and receiver.
- Connect the equipment into an outlet on a circuit different from that to which the receiver is connected.

— Consult the dealer or an experienced radio/TV technician for help.

You are cautioned that any changes or modifications not expressly approved in this manual could void the user’s authority to operate the equipment.

Notes on the Grant:

To comply with Part 15 of the FCC rules, this product must be used with a Fujifilm-specified ferrite-core USB cable and DC supply cord.

For customers in Canada

CAUTION

This Class B digital apparatus complies with Canadian ICES-003.

Please read the Safety Notes (→P.88) and make sure you understand them before using the camera.

Contents

Warning	2
Preface	6
Camera Features and Accessories	7
Nomenclature	8

1 Getting Ready

PREFACE	11
Selecting the Language	11
Attaching the Strap	11
CHARGING AND LOADING THE BATTERIES	12
LOADING THE SmartMedia™	15
REMOVING THE SmartMedia™	16
SWITCHING ON AND OFF	17
SETTING THE DATE AND TIME	19
USING THE OPTIONAL AC POWER ADAPTER	21

2 Basic Photography

STILL IMAGE MODE

📷 TAKING PICTURES (AUTO MODE)	22
■ Viewfinder lamp display	26
Number of Available Frames	27
USING AF/AE LOCK	28
DIGITAL ZOOM	30
4 FRAMING GUIDELINE FUNCTION	31

PLAYBACK MODE

▶ VIEWING YOUR IMAGES (PLAYBACK)	32
PLAYBACK ZOOM	33
MULTI-FRAME PLAYBACK	34
ERASING SINGLE FRAME	35

3 Advanced Features Photography

ADVANCED FEATURES PHOTOGRAPHY	37
-------------------------------------	----

PHOTOGRAPHY MENU

PHOTOGRAPHY MENU OPERATION/ SELECTING 📷 AUTO OR 📷 MANUAL	38
⚡ FLASH	39
AUTO Auto Flash Mode	39
👁 Red-Eye Reduction	40
⚡ Forced Flash	40
👁 Suppressed Flash	41
S⚡ Slow Synchro	41
🌸 MACRO (CLOSE-UP) PHOTOGRAPHY	42
🕒 SELF-TIMER PHOTOGRAPHY	43
📷 EV (EXPOSURE COMPENSATION)	45
WB WHITE BALANCE (SELECTING THE LIGHT SOURCE)	46

MOVIE MODE

🎥 MOVIE (VIDEO)	47
-----------------------	----

4 Advanced Features Playback

PLAYING BACK MOVIES	50
---------------------------	----

PLAYBACK MENU

🗑 ERASING SINGLE • ALL FRAMES/FORMATTING	52
🖨 HOW TO SPECIFY PRINT OPTIONS (DPOF)	54
🗑 DPOF DATE SETTING	55
🗑 DPOF SET FRAME	56

5 Settings

IN SETTINGS	58
■ List of Settings	58
■ SET-UP Menu options	58
USING THE OPTION MENU	59
Using SET-UP	59
SET ⚙ SETTING THE FILE SIZE AND QUALITY (COMPRESSION RATIO)	60
SET ⚙ LCD MONITOR BRIGHTNESS	61
SET-UP	
POWER SAVE	62

6 PC Connection

IN PC CONNECTION	63
DSC Mode	63
PC CAM (camera) Mode	63
CONNECTING AT DSC MODE	64
CONNECTING AT PC-CAMERA MODE	66
DISCONNECTING FROM THE PC	68

System Expansion Options	70
Accessories Guide	71
Explanation of Terms	73
Notes on Using Your Camera Correctly	74
Notes on the Power Supply	75
Applicable Batteries	75
Notes on the Batteries	75
Notes on Using the Battery Charger	76
BC-NHS Battery Charger Specifications	77
Notes on Using the AC Power Adapter	77
Notes on the SmartMedia™	78
Warning Displays	80
Troubleshooting	83
Specifications	86
Safety Notes	88
EC Declaration of Conformity	91

1

2

3

4

5

6

5

Preface

■ Test Shots Prior to Photography

For particularly important photographs (such as weddings and overseas trips), always take a test photograph and view the image to make sure that the camera is functioning normally.

- Fuji Photo Film Co., Ltd. cannot accept liability for any incidental losses (such as the costs of photography or the loss of income from photography) incurred as a result of faults with this product.

■ Notes on Copyright

Images recorded using your digital camera system cannot be used in ways that infringe copyright laws without the consent of the owner, unless intended only for personal use. Note that some restrictions apply to the photographing of stage performances, entertainments and exhibits, even when intended purely for personal use. Users are also asked to note that the transfer of memory cards containing images or data protected under copyright laws is only permissible within the restrictions imposed by those copyright laws.

■ Liquid Crystal

If the LCD monitor is damaged, take particular care with the liquid crystal in the monitor. If any of the following situations arise, take the urgent action indicated.

- If liquid crystal comes in contact with your skin
Wipe the area with a cloth and then wash thoroughly with running water and soap.
- If liquid crystal gets into your eye
Flush the affected eye with clean water for at least 15 minutes and then seek medical assistance.
- If liquid crystal is swallowed
Flush your mouth thoroughly with water. Drink large quantities of water and induce vomiting. Then seek medical assistance.

■ Notes on Electrical Interference

If the camera is to be used in hospitals or aircrafts, please note that this camera may cause interference to other equipment in the hospital or aircraft. For details, please check with the applicable regulations.

■ Handling Your Digital Camera

This camera contains precision electronic components. To ensure that images are recorded correctly, do not subject the camera to impact or shock while an image is being recorded.

■ Trademark Information

- IBM PC/AT is a registered trademark of International Business Machines Corp. of the U.S.A.
- iMac and Macintosh are registered trademarks of Apple Computer, Inc.
- Windows is a registered trademark of the Microsoft Corporation of the U.S. registered in the U.S.A. and other countries. Windows is an abbreviated term referring to the Microsoft Windows Operating System.
- SmartMedia is a trademark of Toshiba Corporation.
- Other company or product names are trademarks or registered trademarks of the respective companies.

Camera Features and Accessories

Features

- Superb image quality provided by the high-resolution Fujinon number 3× zoom lens and 1/2.7" CCD with 2.0 million effective pixels
- Maximum image file size of 1600 × 1200 pixels (1.92 million pixels)
- Compact and lightweight body
- Wide range of photography applications (includes Macro function)
- Intelligent Auto White Balance and AE functions built in
- Built-in automatic flash with precise wide-range flash control
- 2.5× digital zoom photography and up to 5× zoom playback functions
- Easy operation using the Mode switch, “◀▶” buttons and “▲ (L) ▼ (M)” button.
- Movie shooting function (320 × 240 pixels without sound)
- Easy high-speed image file transfer via the USB connection (using the Interface Set provided)
- Built-in PC Camera function
- Conforms to the new standard for digital camera file system*
* Design rule for Camera File system
- Support for DPOF* simplifies print ordering
* DPOF stands for “Digital Print Order Format”

Accessories

- **AA-size Nickel-Metal Hydride (Ni-MH) Batteries HR-3UF (2)**

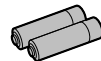

- **SmartMedia (16MB, 3.3V) (1)**

- Supplied with:
- Anti-static case (1)
 - Index label (1)



- **Hand Strap (1)**



- **Battery Charger BC-NHS (1)**



- **Interface Set (1)**

- CD-ROM (1)
- Special USB cable with Noise Suppression core (1)
- Software Quick Start Guide (1)

- **Owner's Manual (this manual) (1)**

Nomenclature

* Refer to the pages in parentheses for information on using the camera features.

【Mode Switch】

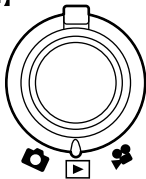

- Still image mode (P.22)
Select this mode for still photography.
- Playback mode (P.32)
This mode provides playback zoom and multi-frame playback as well as normal single-frame playback. You can also use this mode to erase frames, format SmartMedia and specify DPOF settings.
- Movie mode (P.47)

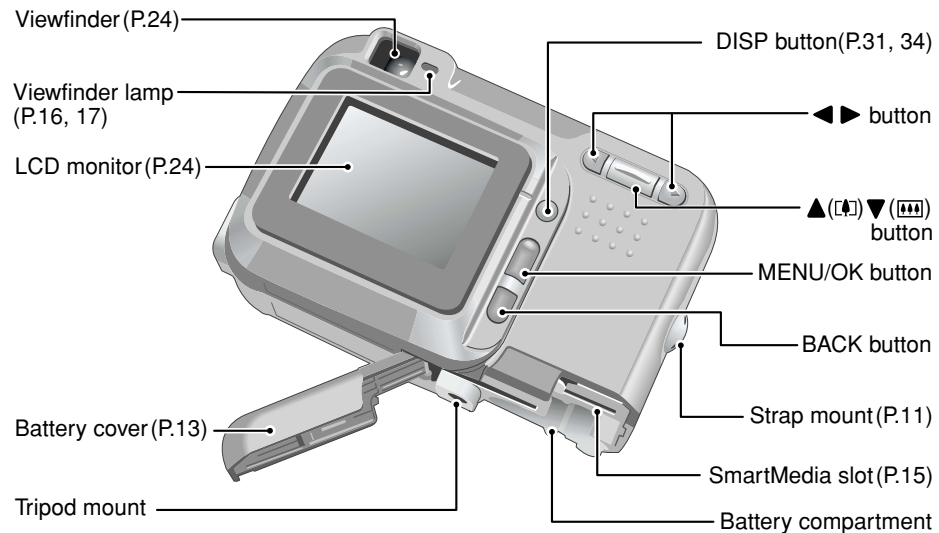
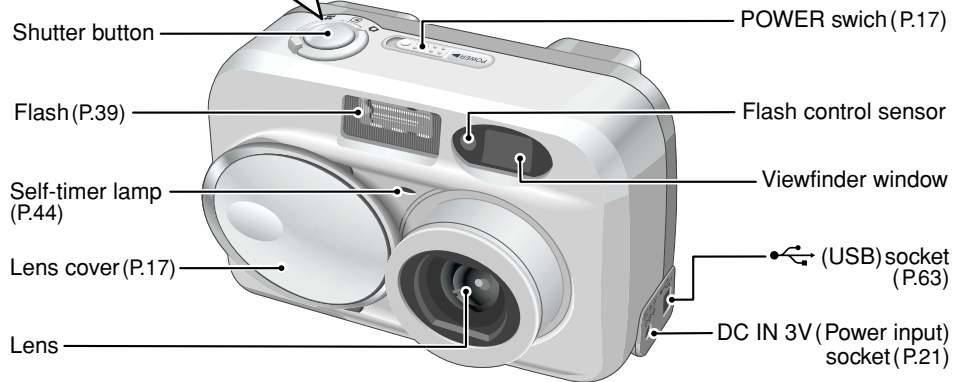

Example of LCD Monitor Text Display : Still image

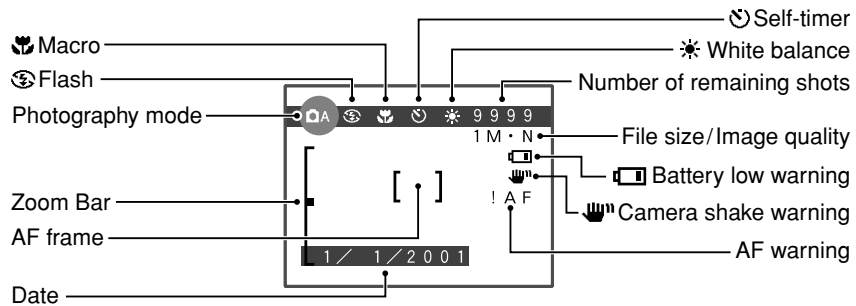

Example of LCD Monitor Text Display : Playback

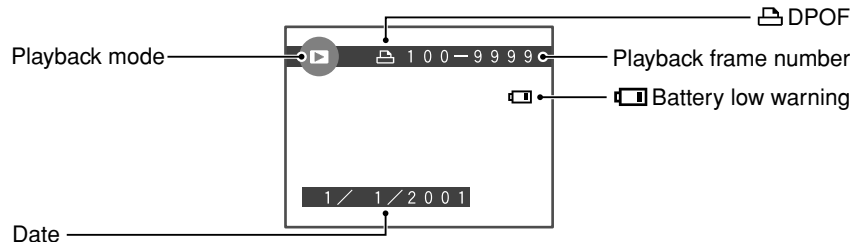

Selecting the Language

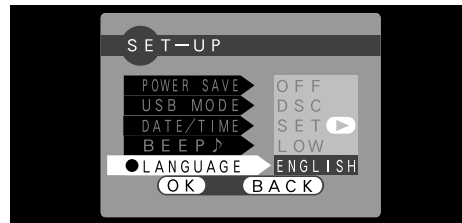

You can use the "SET-UP" screen on this camera to select ENGLISH or FRANCAIS as the LANGUAGE used for screen display (→P.58). The screens in this manual are shown in ENGLISH.

Attaching the Strap

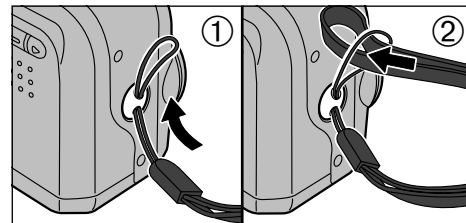

CHARGING AND LOADING THE BATTERIES

Use 2 nickel-metal hydride (Ni-MH) batteries of the same type.

*Lithium, manganese or nickel-cadmium (Ni-Cd) batteries cannot be used.

◆ Batteries that Can Be Charged ◆

● AA-size Ni-MH batteries

Fujifilm HR-3UF: 2 (supplied with the camera or sold separately)

Attempting to charge batteries other than those specified for use with the charger (such as manganese, alkaline or lithium batteries) can cause the batteries to burst or leak. This could result in a fire or injury and consequent damage to the surroundings.

* See P.87 for information on the number of available shots using batteries.

⚠ Alkaline batteries should only be used in an emergency. Note the following when using alkaline batteries:

- The battery terminals should be wiped clean with a clean, dry cloth.
- Always switch the LCD monitor off (⇒P.22) before using alkaline batteries. Alkaline batteries cannot be used in Manual mode, Macro mode or Movie mode.
- The number of available shots is limited and varies depending on the battery brand and ambient temperature. You may be unable to take pictures at all at temperatures of +5°C (+41°F) or below.
- If the LCD monitor is switched off, the camera switches off without first displaying a battery low warning when the battery charge runs out.

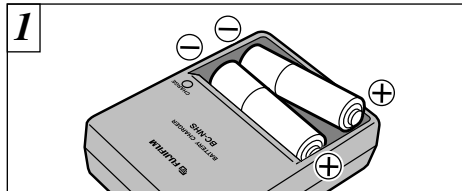

1 Load the rechargeable batteries into the battery charger as indicated on the label.

⚠ Ni-MH batteries are not fully charged at shipment and must be charged before being used. Newly purchased batteries or batteries that have been left unused for an extended period may not be fully charged (This is indicated by the immediate display of the battery low warning or a low number of available shots). This is a normal characteristic of the batteries and does not indicate a fault. Repeatedly charging and using the batteries 3 or 4 times will restore them to a normal condition.

⚠ If the terminals of nickel-metal hydride batteries are soiled, it may not be possible to charge them. To avoid possible problems, clean the battery terminals and charger terminals with a clean, dry cloth. (Clean the battery and charger terminals with a clean, dry cloth the first time the batteries are charged. Then insert and remove the batteries from the charger several times prior to charging.)

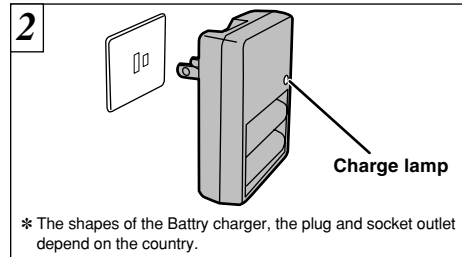

2 Plug the charger into a power outlet to begin charging. Charging ends after about 5 hours and the charging lamp goes off. Unplug the battery charger from the power outlet when it is not in use.

* The shapes of the Battery charger, the plug and socket outlet depend on the country.

⚠ Fully discharged Ni-MH batteries take approximately 5 hours (1700 mAh) to recharge. Shorter charging times can be achieved using the Ni-MH/Battery Charger BCH-NH (⇒P.71).

⚠ If you repeatedly charge a Ni-MH battery before it is fully discharged, it will suffer from the "memory effect"*, causing the battery low warning to appear while there is still ample charge remaining in the batteries. You can restore the batteries to normal operation by running the batteries completely flat before charging them.

* Memory effect: A phenomenon whereby the batteries properties are such that its capacity is lower than the nominal amount.

⚠ Do not use old and new batteries together.

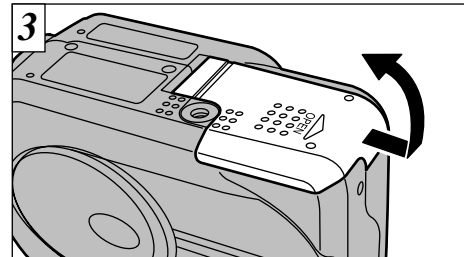

3 Slide the battery cover out to open it.

⚠ Install the equipment near a socket outlet for easy accessibility.

⚠ Do not apply excessive force to the battery cover.

⚠ If you connect the optional AC power adapter or leave the batteries in the camera for roughly 10 minutes, the settings will be retained for approximately 12 hours even if you disconnect the AC power adapter or remove the batteries. After replacing the batteries, check the date/time settings, etc.

CHARGING AND LOADING THE BATTERIES

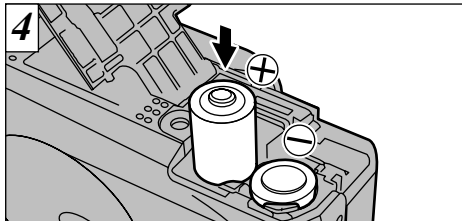

Install the batteries with the correct polarity as shown.

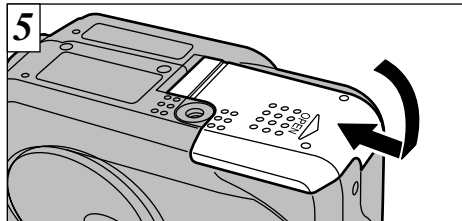

Close the battery cover.

- ⚠ Soil (fingerprints, etc) on the terminals of batteries can greatly reduce the time for which the batteries provide power.
- ⚠ When taking pictures, keep a spare set of fully charged Ni-MH batteries (sold separately) in reserve.
- ⚠ Take care not to drop the batteries when opening and closing the battery cover.

14 ⚠ See P.75 for notes on using the batteries.

LOADING THE SmartMedia™

SmartMedia™(Sold separately)

■ Only use 3.3V SmartMedia

MG-4S (4MB), MG-16SW (16MB, ID)
MG-8S (8MB), MG-32SW (32MB, ID)
MG-16S (16MB), MG-64SW (64MB, ID)
MG-32S (32MB), MG-128SW (128MB, ID)
MG-64S (64MB)

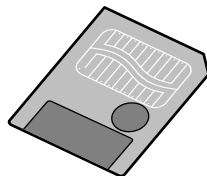

- ⚠ Images cannot be recorded or erased if a write-protect sticker is affixed to the SmartMedia.
- ⚠ Operation of this camera is only guaranteed when it is used with Fujifilm SmartMedia.
- ⚠ Some 3.3V SmartMedia are labelled as "3V" or "ID" cards.
- ⚠ See P.78 for more information on SmartMedia.

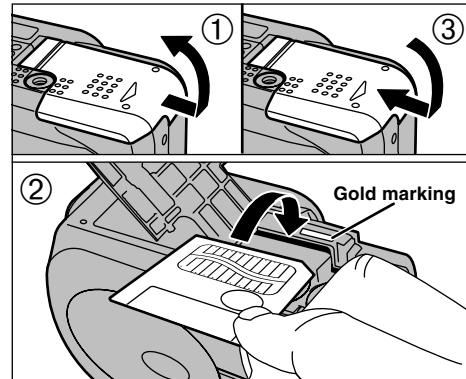

- ① Check that the camera is turned off. Then turn the camera so that the battery cover is upwards and slide the cover open.
 - ② Push the SmartMedia firmly into the SmartMedia slot as far as it will go.
 - ③ Close the battery cover.
- ⚠ If you open the battery cover while the camera is switched on, the camera is automatically switched off to protect the SmartMedia.
 - ⚠ The SmartMedia will not slide fully into the slot if it is inserted facing the wrong way. Be careful not to apply undue force to the SmartMedia.

15

REMOVING THE SmartMedia™

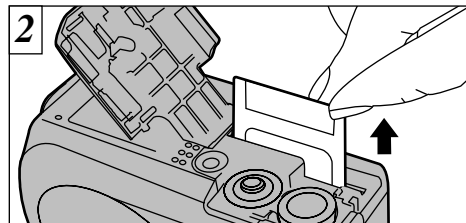
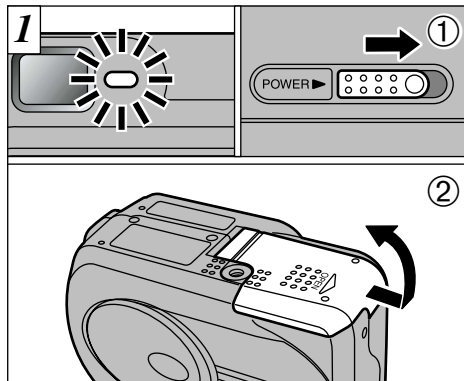

Carefully grasp and remove the SmartMedia. Take care to avoid spilling the batteries.

⚠ To protect the SmartMedia, always store it in the special anti-static case.

◆ Printing Images and Downloading Images to a Personal Computer ◆

- See P.54, 70 for information on printing images.
- See P.63 – 69 for information on downloading images to a personal computer.

- ① Check that the indicator in the viewfinder is green and then switch the camera off (→P.17).
- ② Always turn the camera so that the battery cover is upwards before sliding the cover open.

Never open the Battery cover while the camera is switched on. This could destroy the image file or damage the SmartMedia itself.

SWITCHING ON AND OFF

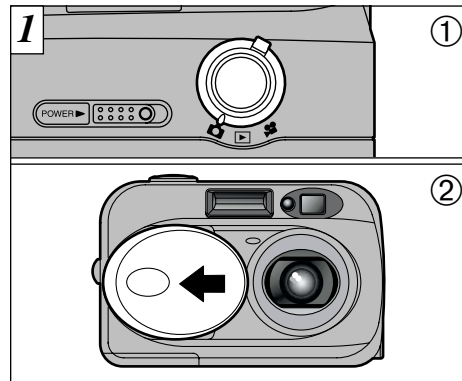

- ① Use the Mode switch to select the mode you want to use.
 - ② If you want to use the camera in Still image/Movie mode, open the lens cover.
- ⚠ Open and close the lens cover by fitting your finger into the indentation in the cover.

◆ Auto Power Off function ◆

If you leave the camera switched on and unused for 2 minutes, this function automatically switches the camera off. Note that this function does not operate when you are using a USB connection.

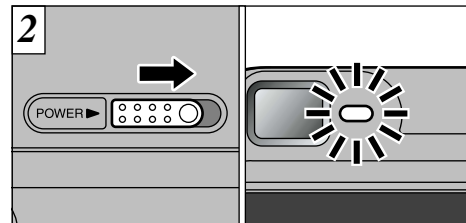

When you slide the “POWER” switch sideways to switch the camera on, the green viewfinder lamp lights. To switch the camera off, slide the “POWER” switch sideways again.

- ⚠ Take care not to press on the lens when it is extending or while you are taking a shot as this could cause a camera fault.
- ⚠ If the “LENS COVER” message appears on the LCD monitor, this indicates that the lens cover is not fully open. Open the lens cover fully.

SWITCHING ON AND OFF



If the date/time setting has been cleared, a confirmation message appears on the LCD monitor. To set the date/time, press the "MENU/OK" button (➡ P.19).

OK: The DATE/TIME setting screen appears.

BACK: The camera remains in Still image, Movie or playback mode.

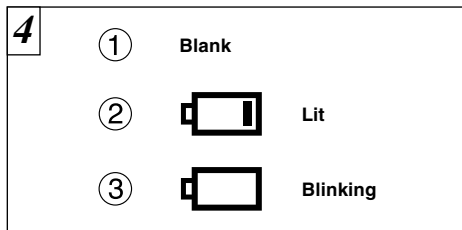

With the LCD monitor on, you can check the remaining charge in the battery.

① Battery has ample charge (No indicator displayed).

② The battery charge is low. Have a new set of batteries ready.

③ The battery is exhausted. The display will shortly go blank and the camera will stop working. Replace or recharge the battery.

! If the battery charge is depleted, you may not be able to switch the LCD monitor on.

SETTING THE DATE AND TIME

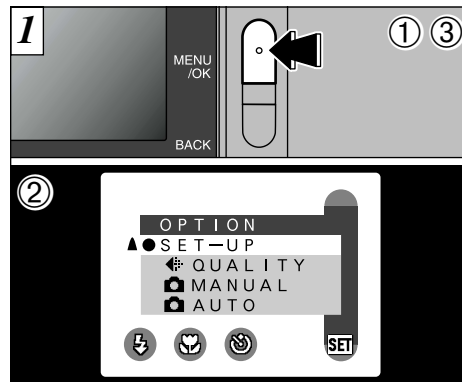

① Press the "MENU/OK" button to display the menu screen.

② Use "◀" or "▶" to select "SET", and then use "▲ (L)" or "▼ (H)" to select "SET-UP".

③ Press the "MENU/OK" button.

If the date was cleared and you selected "**OK**", proceed from step 3 (➡ P.20).

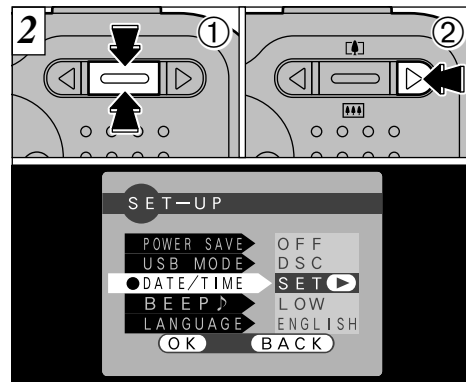

① The "SET-UP" screen appears. Use "▲ (L)" or "▼ (H)" to select "DATE/TIME".

② Press "▶".

! See P.58 for more information on the "SET" OPTION menu.

! If at least 10 minutes have passed since the AC power adapter was connected or the battery inserted and date and time set, then those settings will be maintained for roughly 12 hours even when the camera has no power supply (when the AC power adapter is disconnected and the battery is removed).

SETTING THE DATE AND TIME

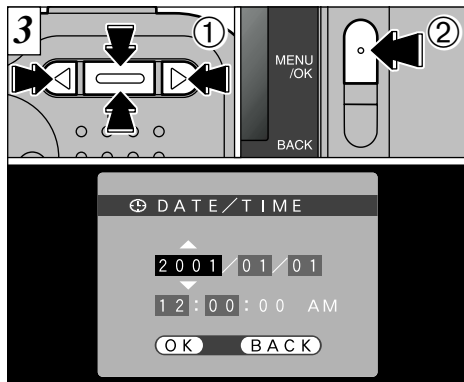

① Use the “◀▶” button to select the desired item and then use the “▲ (L)” and “▼ (R)” buttons to correct the setting.

② When you have finished setting the date and time, press the “MENU/OK” button to confirm the setting.

⚠ If you hold down the “▲ (L)” or “▼ (R)” button, the numbers change continuously.

⚠ When the time displayed passes “12:00:00”, the AM/PM setting automatically switches.

⚠ To set the time precisely, press the “MENU/OK” button when the time is at zero seconds.

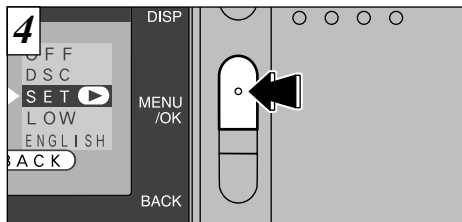

The “SET-UP” screen reappears. Press the “MENU/OK” button to exit the settings screen.

If the date/time setting was cleared and you selected “OK”, the camera switches directly to still image, movie or playback mode without displaying the “SET-UP” screen.

USING THE OPTIONAL AC POWER ADAPTER

AC power adapter (optional)

Always use a FUJIFILM AC Power Adapter AC-3V.

Use the AC power adapter in situations when a loss of power will cause problems, such as during file downloading (via the USB connection). Using the AC power adapter also allows you to take pictures and play back images without worrying about depleting the batteries.

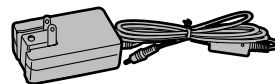

- ⚠ See P.77 for notes on using the AC power adapter.
- ⚠ Only connect or disconnect the AC power adapter when the camera is switched off.

Connecting or disconnecting the AC power adapter while the camera is switched on temporarily interrupts the power supply to the camera, so that images or movies being shot at the time are not recorded. Failing to switch the camera off first can also result in damage to the SmartMedia or malfunctions during PC connection.

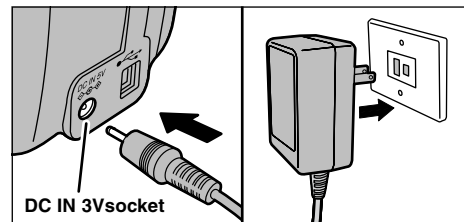

Check that the camera is switched off. Plug the AC power adapter connector into the DC IN 3V socket on the camera and then plug the adapter itself into the main power outlet.

- ⚠ The Shapes of the AC power adapter, the plug and socket outlet depend on the country.
- ⚠ Install the equipment near a socket outlet for easy accessibility.

Connecting the AC power adapter does not allow you to charge the Ni-MH batteries. You must use the charger provided (→P.12) or the optional charger (→P.71) to charge NiMH batteries.

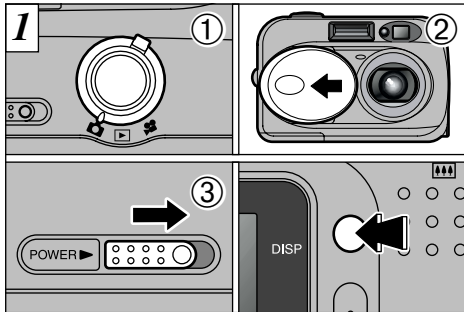

- ① Set the Mode switch to “”.
- ② Open the lens cover.
- ③ Slide the “POWER” switch sideways to switch the camera on.

To take pictures using the LCD monitor, press the “DISP” button to switch the LCD monitor on.

● **Focal range:** Approx. 80 cm (2.6 ft.) to infinity

- ⚠ If “”, “” or “” is displayed, first wipe the contact surface on the SmartMedia (gold-colored area) thoroughly with a soft, dry cloth and then reload the SmartMedia.



Loop the strap over your wrist, brace your elbows firmly against your body and hold the camera with both hands.

- ⚠ For subjects closer than 80 cm (2.6 ft.), use Macro photography (➔P.42).
- ⚠ To minimize power consumption, you should use the viewfinder (switch the LCD monitor off) to take pictures.
- ⚠ The image will be blurred if the camera moves when you take the picture (camera shake). When you are shooting in low-light conditions, use the flash (➔P.39) or a tripod to prevent blurred images due to camera shake.

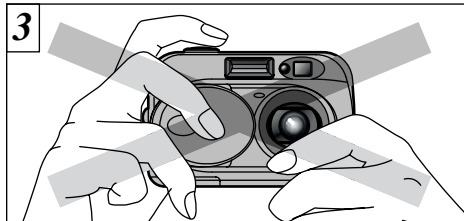

Ensure that your fingers or the camera strap do not obscure the lens or flash control sensor.

- ⚠ If the lens, flash or flash control sensor is obscured by your fingers or the camera strap, you may not be able to obtain the correct brightness (exposure) for your shot.
- ⚠ Check that the lens is clean. If it is dirty, clean the lens as described on P.74.

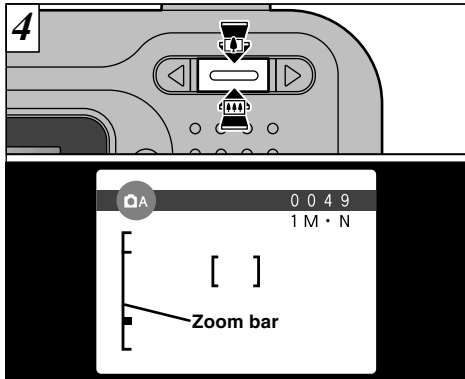

To zoom in on the subject, press “” (TELE). To zoom out, press “” (WIDE). A “zoom bar” appears on the LCD monitor when you zoom in or out.

● **Optical zoom focal length (35mm camera equivalent)**

Approx. 38 – 114 mm
Maximum zoom scale: 3×

- ⚠ Zooming stops briefly when the camera switches between optical zoom and digital zoom (➔P.30).

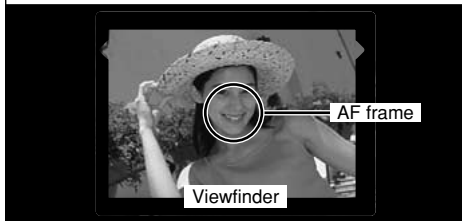
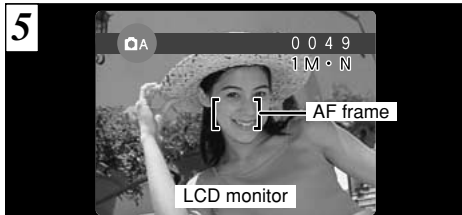

Using the viewfinder or LCD monitor, frame your shot so that the subject fills the entire AF (Auto Focus) frame.

- ⚠ If your subject is not in the center of the picture, use AF/AE lock to take the picture(⇒P.28).

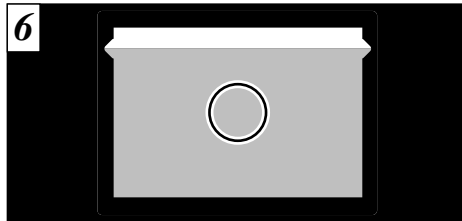

When you are using the viewfinder to take a picture at a distance of 0.8 m to 1.5 m (2.6 ft. to 4.9 ft.), only the shaded area in the figure is photographed.

- ⚠ To frame your shot precisely, you should take the picture using the LCD monitor.
- ⚠ In some conditions it may be difficult to see your subject clearly on the LCD monitor, such as in sunny weather outdoors or when you are shooting dimly lit scenes. In such situations, use the viewfinder to take the shot.
- ⚠ When you press the shutter button down halfway, the video image on the LCD monitor freezes briefly. However, this is not the image that is recorded.
- ⚠ If the shot is too dark to focus, try standing about 1.5 m (4.9 ft.) from your subject to take the picture.

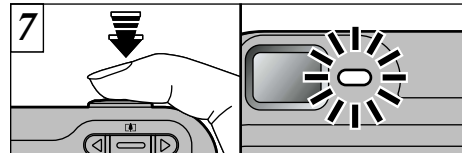

Press the shutter button down halfway. The camera is focused when the AF frame on the LCD monitor shrinks and the green viewfinder lamp stops flashing and stays lit.

- ⚠ If you press the shutter button down fully in one motion, the shot is taken without the AF frame changing.
- ⚠ The viewfinder lamp flashes orange while the flash is charging. If the LCD monitor is switched on, the screen may go dark for a moment. This is normal and does not indicate a fault.
- ⚠ The flash charging time may increase when the battery charge getting lower.

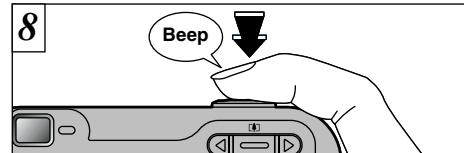

To take the picture, press the shutter button down fully without lifting your finger off it. The camera beeps and takes the picture, and the data is then recorded.

- ⚠ When you press the shutter button, there is a very short delay before the picture is actually taken.
- ⚠ Since the amount of image data recorded is not fixed and varies depending on the subject (level of image detail, etc.), the number of available shots may not decrease after the image is recorded, or may decrease by 2.
- ⚠ See P.80 – 82 for information on the warning displays.

The viewfinder lamp glows orange while the image is being recorded and no pictures can be taken. Also, do not switch the camera off or open the battery cover during image recording. Doing cover during image recording could corrupt the image files.

■ Viewfinder lamp display

Display	Status
Lit green	Ready to shoot.
Blinking green	AF/AE in progress or camera shake/AF warning.
Lit orange	Image being recorded onto the SmartMedia.
Blinking orange	Flash charging.
Blinking red	<ul style="list-style-type: none"> SmartMedia warning. No SmartMedia loaded, SmartMedia not formatted, incorrect format, write-protect sticker used, SmartMedia full, SmartMedia error. Lens operation error.

* When the LCD monitor is switched on, more detailed warning messages are displayed (➡P.80).

◆ Subjects Not Suitable for Autofocus ◆

Though the FinePix2600 ZOOM uses an accurate autofocus mechanism, it may have difficulty focusing or not be able to focus at all on the types of subject and situation listed below. In such cases, the image may be out of focus.

- Very shiny subjects such as a mirror or car body.
- Subjects photographed through glass.
- Subjects that do not reflect well, such as hair or fur.
- Subjects with no substance, such as smoke or flames.
- When the subject is dark.
- When there is very little contrast between the subject and the background (such as white walls or subjects dressed in the same color as the background).
- When there are objects in front of or behind the subject (such as an animal in a cage or a person in front of a tree).
- Subjects moving at high speed.

Number of Available Frames

The number of available shots appears on the LCD monitor.

- ! See P.60 for information on changing the File Size (Image Size) and Quality setting.
- ! At shipment, the default settings are "1M" (file size) and "N : NORMAL" (quality).

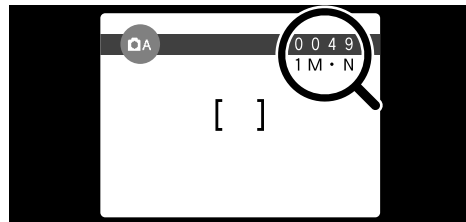

■ Standard number of shots per SmartMedia™

The number of shots that can be recorded onto a SmartMedia card varies slightly depending on the type of subject. Also, the difference between the standard number of shots and the actual number of available shots increases for SmartMedia with a higher capacity.

File Size	2M 1600 × 1200			1M 1280 × 960		VGA 640 × 480
	FINE	NORMAL	BASIC	FINE	NORMAL	NORMAL
Quality Mode						
Image Data Size	Approx.770KB	Approx.390KB	Approx.200KB	Approx.620KB	Approx.320KB	Approx.130KB
4MB (MG-4S)	4	9	19	6	12	30
8MB (MG-8S)	10	19	39	12	25	61
16MB (MG-16S/SW)	20	39	75	25	49	122
32MB (MG-32S/SW)	41	79	152	50	99	247
64MB (MG-64S/SW)	82	159	306	101	198	497
128MB (MG-128SW)	166	319	613	204	398	997

* The numbers of available shots are shown for formatted SmartMedia. 27

USING AF/AE LOCK

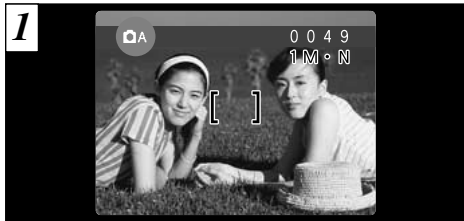

In a shot with this type of composition, the subjects (two people in this case) are not in the AF frame. If the shot is taken at this point, the subjects will not be in focus.



Move the camera slightly so that one of the subjects in the AF frame.

◆ AF (Autofocus)/AE (Auto exposure) Lock ◆

On the FinePix2600 ZOOM, when you press the shutter button down half way, the focus and exposure settings are fixed (AF/AE lock). If you want to focus on a subject that is off to one side of the image or if you want to set the exposure before you compose the final shot, lock the AF and AE settings and then compose and shoot your picture to get the best results.

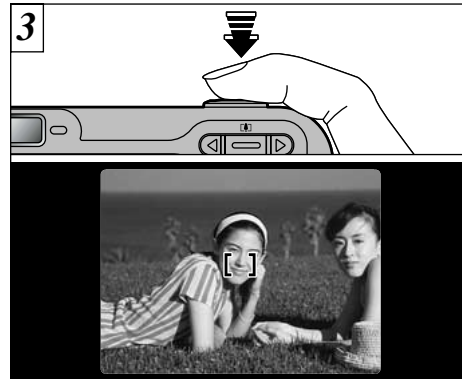

Without moving the camera, press the shutter button down halfway (AF/AE lock). Check that the AF frame on the LCD monitor has shrunk and the green viewfinder lamp has stopped flashing and is now lit.

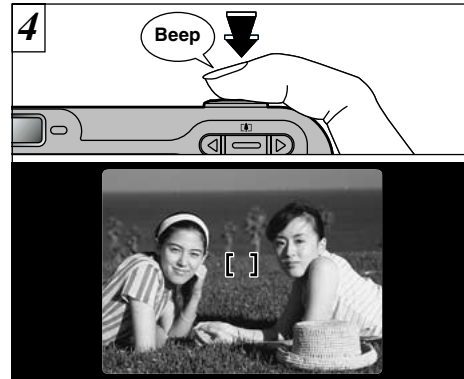

Continue to hold the shutter button down halfway. Move the camera back to the original image and then fully press down on the shutter button.

- ! You can reapply the AF/AE lock as many times as you like before releasing the shutter.
- ! The AF/AE lock operates in all photography modes and can be used to ensure excellent results.

DIGITAL ZOOM

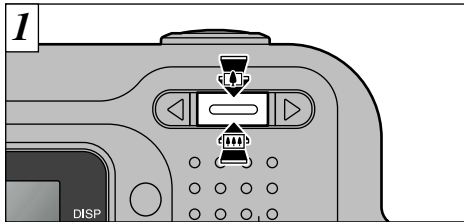

If the file size (image size) setting is “1M” or “VGA”, you can use the digital zoom. However, this only applies when you are using the LCD monitor to take pictures.

● Digital zoom focal distance (35 mm camera equivalent)

1M : Equivalent to approx. 114 mm – 142 mm (1.25×)

VGA : Equivalent to approx. 114 mm – 285 mm (2.5×)

Movie: Equivalent to approx. 38 mm – 95 mm (2.5×)

⚠ You cannot use the digital zoom for resolutions of “2M”.

⚠ See P.60 for information on changing the file size setting.

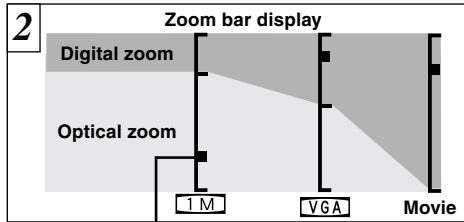

The position of the “■” on the zoom bar indicates the current zoom setting.

- If the “■” is above the dividing line, the digital zoom is being used. If it is below the line, the optical zoom is being used.
- Press “” or “” to move the “■”.
- When you switch between digital zoom and optical zoom, the “■” stops moving. Press the button for the same direction again to start the “■” moving again.

⚠ If the image goes out of focus when you use the zoom, press the shutter button down halfway to refocus.

⚠ The optical zoom is equivalent to approximately 38 mm – 114 mm on a 35 mm camera.

FRAMING GUIDELINE FUNCTION

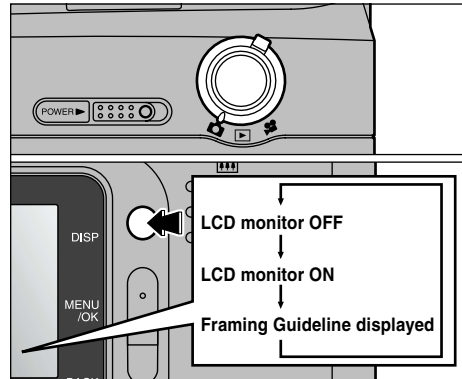

You can select the Framing Guideline function in the “A” still image mode. The LCD monitor display changes each time you press the “DISP” button. Press the “DISP” button until “Framing Guideline” appears.

- ⚠ The framing guideline is not recorded on the image.
- ⚠ The lines in the scene frame roughly divide the recorded pixels into three equal parts horizontally and vertically. When the image is printed, the resulting print may be shifted slightly from the scene frame.

Scene

Use this frame when you want to position your main subject in the center of the frame or when you want to align your shot with the horizon. This feature allows you to compose a shot that captures the moment while focusing on the subject size and the overall balance of the shot.

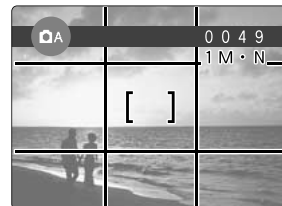

◆ Important ◆

Always use the AF/AE lock to compose your picture. Failing to use the AF/AE lock may result in the image being out of focus.

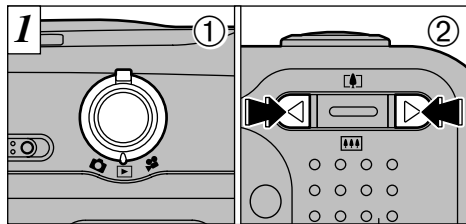

- ① Set the Mode switch to "▶".
- ② You can use "▶" and "◀" to move forward and backward respectively through your images.

⚠ When you set the Mode switch to "▶", the last image shot is displayed.

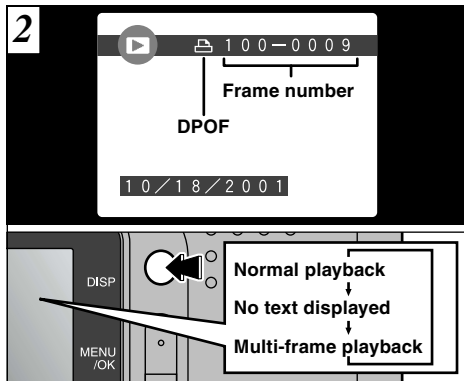

If you have specified DPOF settings (→P.54), the "📄" icon is displayed. The LCD monitor display changes each time you press the "DISP" button.

⚠ See P.61 for more information on adjusting the brightness of the LCD monitor.

◆ Images That Can be Viewed on the FinePix2600 ZOOM ◆

You can use this camera to view (excluding some uncompressed data) images recorded on a FinePix2600 ZOOM or images recorded onto a 3.3V SmartMedia using a FUJIFILM FinePix series, MX series or DX series digital camera.



Pressing "▲ (📄)" or "▼ (📄)" during single-frame playback zooms in (enlarges) or out on a still image. When you use this function, a zoom bar is displayed.

● Zoom scales:

2M	1600 × 1200 pixels: Max 5×
1M	1280 × 960 pixels: Max 4×
VGA	640 × 480 pixels: Max 2×

⚠ Pressing "◀" or "▶" during zooming cancels zooming and moves to the next image.

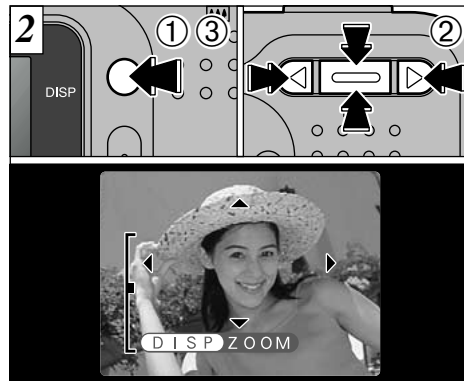

After you have zoomed in on your image,

- ① Press the "DISP" button.
 - ② Use "▲ (📄)" ▼ (📄)" and "◀▶" to zoom in on different parts of the image.
 - ③ Press the "DISP" button again to revert to zoomed display.
- ⚠ Press the "BACK" button to revert to the normal image display scale.
⚠ You may not be able to use playback zoom for some images shot on other camera models.

This is useful for such things as checking the focus after you take a shot.

MULTI-FRAME PLAYBACK

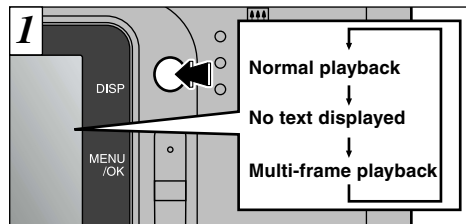

In playback mode, the display shown on the LCD monitor switches each time you press the “DISP” button. Press the “DISP” button until the multi-frame playback screen (9 frames) appears. You cannot display text during multi-frame playback.

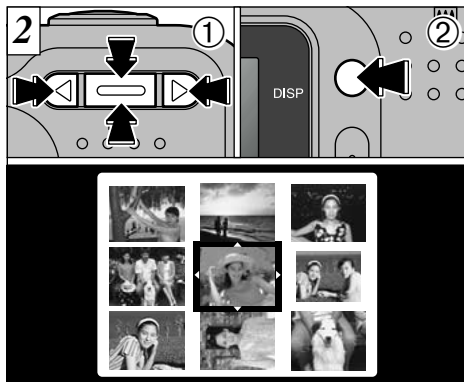

- ① Select a frame by using “◀”, “▶”, “▲ (L/4)” and “▼ (R/4)” to move the cursor (the orange box) to the desired frame. Press “▲ (L/4)” or “▼ (R/4)” several times to switch to the previous page or the next page.
- ② You can enlarge the selected image by pressing the “DISP” button again.

- ⚠ You cannot use multi-frame playback while a menu is displayed.
- ⚠ Playback zoom cannot be used with multi-frame playback.

ERASING SINGLE FRAME

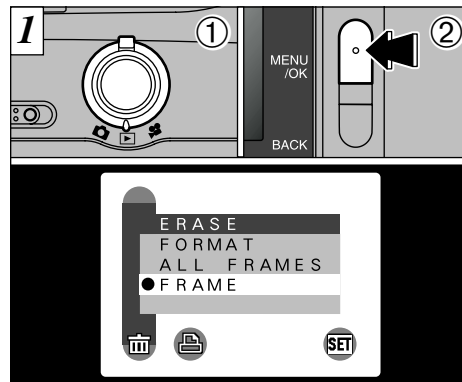

- ① Set the Mode switch to “▶”.
- ② Press the “MENU/OK” button to display the Menu screen on the LCD monitor.

⚠ See P.52 for more details of the “ERASE” menu.

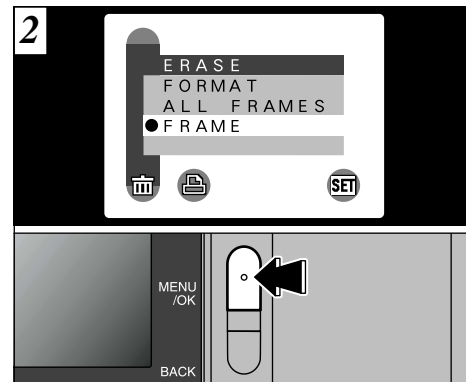

Select “FRAME” in the “ERASE” menu and press the “MENU/OK” button.

ERASING SINGLE FRAME

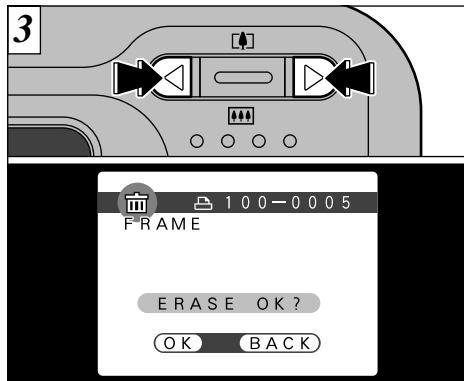

Press “◀” or “▶” to display the image to be erased.

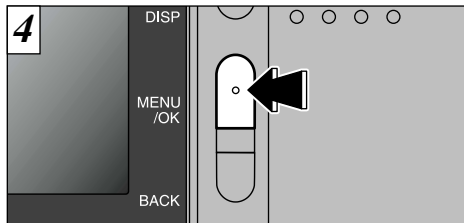

Press the “MENU/OK” button to erase the displayed image. When erasing is complete, the next image appears and the “ERASE OK?” message is displayed.

- ⚠ If the “! PROTECTED FRAME” message appears, you cannot erase the frame. Use the camera on which the frame was protected to unprotect the frame.
- ⚠ “! DPOF” is displayed for frames with DPOF settings and they cannot be erased (➡P.82).

To continue erasing images, repeat the procedure from step 3.

The Advanced Features Photography section introduces a range of camera functions that you can access by setting the Mode switch to “📷” or “🎥”.

■ Photography mode specifications

Mode switch	Photography mode	Accessible menu settings	Factory default	Shared menu settings
📷 Still image	📷 AUTO This is the easiest mode for taking pictures and can be used in a wide range of conditions.	⚡ Flash (➡P.39) 🌸 Macro (➡P.42) ⌚ Self-timer (➡P.43)	AUTO OFF OFF	[SET] OPTION *See P.58 for more information on each of the settings.
	📷 MANUAL This mode allows you to specify the “EV” and “WHITE BALANCE” settings.	⚡ Flash (➡P.39) 🌸 Macro (➡P.42) [EV] EV (EXPOSURE COMPENSATION) (➡P.45) [WB] White balance (Selecting the Light Source) (➡P.46)	AUTO OFF 0 AUTO	
🎥 Movie (Video)	🎥 MOVIE (➡P.47) In this mode, you can shoot up to 20 seconds of video at a time.	—	—	

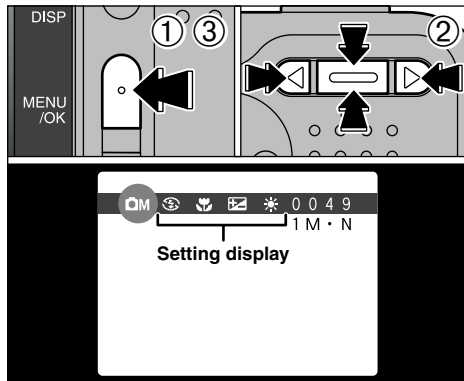

- ① Press the “MENU/OK” button to display the menu.
- ② Use “◀” and “▶” to select the menu item and “▲ (□)” and “▼ (■)” to change the setting.
- ③ Press the “MENU/OK” button to confirm the setting.

When you validate the settings, the respective icons appear at the top of the screen.

⚠ The settings available in the menu screen differ depending on the photography mode. See P.37 for details.

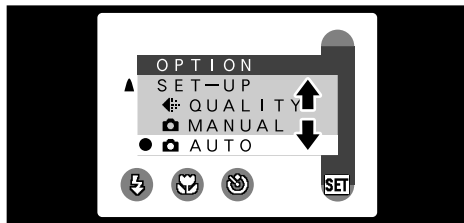

When you are in still image mode (with the Mode switch set to “”), you can switch to “ AUTO” mode or “ MANUAL” mode from “ OPTION” in the photography menu.

AUTO

This is the easiest mode for taking pictures and can be used in a wide range of conditions.

MANUAL

This mode allows you to set the “EV” and “WHITE BALANCE” settings.

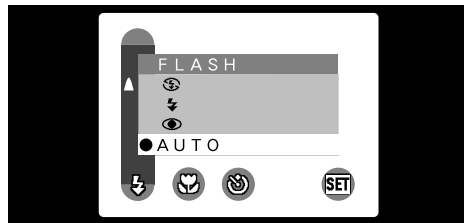

This mode can be selected in the “A • M” still image modes.

Use the flash mode that best suits your shot.

- **5 modes:** “AUTO, , , and S”
- **Effective flash range (for A AUTO)**

Wide-angle: Approx. 0.2 m to 3 m
(0.6 ft. to 9.8 ft.)

Telephoto : Approx. 0.8 m to 3 m
(2.6 ft. to 9.8 ft.)

- ⚠ The flash charging time may increase if the charge remaining in the batteries is low.
- ⚠ When you take a shot using the flash, you may see the video image disappear and the screen go dark as the flash charges. The viewfinder lamp flashes orange while the flash is charging.
- ⚠ If you use the flash in very dusty environments, floating dust particles may appear as glowing white dots on your image.



AUTO Auto Flash Mode

Use this mode for ordinary photography. The flash fires automatically as required by the shooting conditions.



👁 Red-Eye Reduction

Use this mode to ensure that the subject's eyes appear natural when photographing people in low-light conditions. The flash fires automatically as required by the photography conditions. The flash fires a pre-flash just before the picture is taken and then fires again to take the actual picture.

◆ **Red-Eye Effect** ◆

When you use the flash to photograph people in low-light conditions, their eyes sometimes appear red in the picture. This is caused by the light of the flash reflecting off the inside of the eye. Use Red-Eye Reduction flash to effectively minimize the likelihood of the red-eye effect. Take the following measures to make Red-Eye Reduction more effective :

- Get the subjects to look at the camera.
- Get as close as possible to the subjects.



⚡ Forced Flash

Use this mode to photograph backlit scenes, such as a subject against a window or in the shade of a tree, or to obtain the correct colors when you are shooting under lighting such as fluorescent tubes. In this mode, the flash fires in bright as well as dark conditions.



🌙 Suppressed Flash

Use this mode for photography using indoor lighting, for shots taken through glass, and for photography in venues such as theaters or at indoor sporting events where the distance is too great for the flash to be effective. When you use Suppressed Flash, the Automatic White Balance function (➔P.73) operates so that natural colors are captured along with the ambience of the available light.

- ⚠ If you are shooting in Suppressed Flash mode in dark conditions, use a tripod to prevent camera shake.
- ⚠ See P.26, 81 for information on the camera shake warning.



S⚡ Slow Synchro

This is a flash mode that uses a slow shutter speed. This allows you to take pictures of people at night that clearly show both your subjects and the night time backdrop.

- ⚠ The image may be overexposed when you shoot bright scenes.
- ⚠ Because a slow shutter speed is used, a tripod should be used to prevent camera shake.

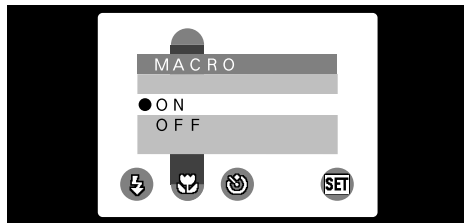

Selecting Macro mode specifies the following camera settings:

- The lens is fixed to the wide-angle zoom setting and only digital zooming is available.
- The LCD monitor is fixed to the ON setting.
- Switching the camera off cancels Macro mode.

You can select Macro mode in the “**QA**” and “**QM**” photography modes. Use Macro mode for close-up shots.

- **Focal range:** Approx. 10 – 80 cm (approx. 20 – 80 cm when the flash is used)
- **Digital zoom focal distance (35 mm camera equivalent)**

[1M] : Equivalent to approx. 38 mm – 48 mm (1.25x)

[VGA] : Equivalent to approx. 38 mm – 95 mm (2.5x)

- When shooting in dark conditions, use a tripod to prevent camera shake.

If you use the viewfinder to take pictures in Macro mode, there is a discrepancy between what you see and what the camera actually photographs due to the difference in the positions of the lens and the viewfinder window. For this reason, you should always use the LCD monitor when shooting in Macro mode.

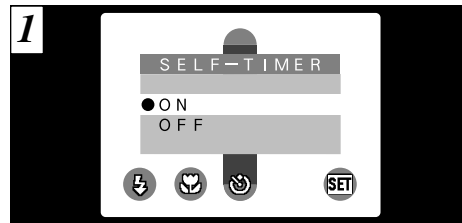

This mode can be selected in the “**QA**” photography modes. In this mode a timer runs for roughly 10 seconds before the shutter is released. Use this mode for shots such as photographs of yourself.

- The self-timer is automatically cancelled in the following situations:
 - When you take a picture.
 - When you switch between Photography mode and playback mode.
 - When the camera is switched off.

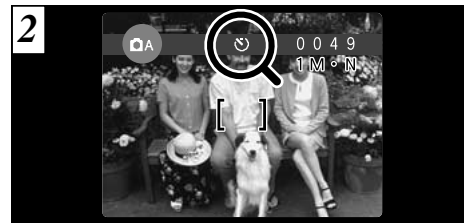

Position the AF frame over the subject and press the shutter button. The camera focuses on the subject in the frame and self-timer starts to run.

- You can also use the AF/AE lock (→P.28).
- Be careful not to stand in front of the lens when you press the shutter button as this can cause focusing or light metering errors.

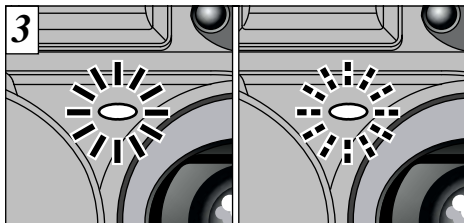

The self-timer lamp lights steadily for roughly 5 seconds and then blinks for another 5 seconds, after which the shot is taken.

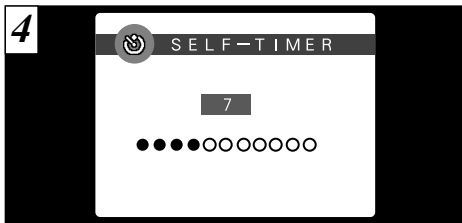

The time until the shutter releases is shown as a countdown bar on the LCD monitor. Self-timer mode is automatically cancelled after each shot.

44 To stop the self-timer, once it has started running, press the "BACK" button.

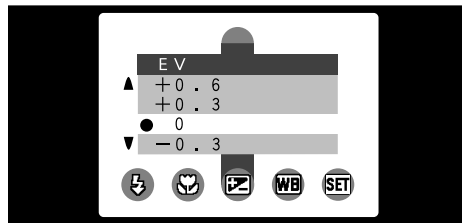

This mode can be selected in the "CAM" photography mode. Use the Brightness setting to obtain the optimum image brightness (exposure) when the subject is much brighter or darker than the background.

- **Correction range:** 11 steps
(-1.5 EV to +1.5 EV in 0.3 EV increments)
See P.73 for more information on EV.

- Exposure compensation is disabled in the following situations :
 - When the flash is used in Auto or Red-eye Reduction mode.
 - When Forced Flash mode is used and the scene photographed is dark.

◆ Subjects for Which Exposure Adjustment is Particularly Effective ◆

Guide to using + (positive) compensation

- Copying of printed text (black characters on white paper) (+1.5 EV)
- Backlit portraits (+0.6 EV to +1.5 EV)
- Very bright scenes (such as snowfields) and highly reflective subjects (+0.9 EV)
- Shots made up predominantly of sky. (+0.9 EV)

Guide to using - (negative) compensation

- Spotlit subjects, particularly against dark backgrounds (-0.6 EV)
- Copying of printed text (white characters on black paper) (-0.6 EV)
- Scenes with low reflectivity, such as shots of pine trees or dark foliage (-0.6 EV)

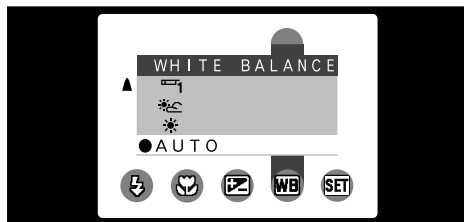

This mode can be selected in the “**OM**” photography mode.

Change the white balance setting when you want to take a picture with the white balance fixed for the surroundings and lighting when the picture is taken.

In Auto mode, the correct white balance may not be obtained for subjects such as close-ups of people’s faces and shots taken under a special light source. In such situations, select the correct white balance for the light source. See P.73 for more information on the white balance.

AUTO: Automatic adjustment
(Shooting to show the ambience of the light source)

- : Shooting outdoors in fine weather
- : Shooting in shade
- : Shooting under “Daylight” fluorescent lamps
- : Shooting under “Warm White” fluorescent lamps
- : Shooting under “Cool White” fluorescent lamps
- : Shooting in incandescent light

* Because the white balance setting is disabled during flash photography, use “Suppressed Flash” mode (→P.41) if you want to achieve a particular effect in your shot.

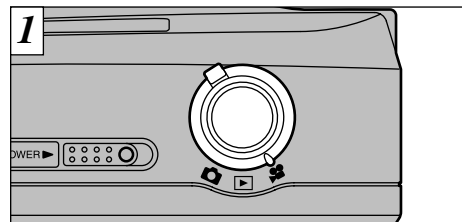

Set the Mode switch to “**Movie (Video)**”

Movie (Video)

Use this mode to shoot up to 20 seconds of video per movie.

- **Movie format:** Motion JPEG (→P.73)
320 × 240 pixels
10 frames per second
Without sound

- ⚠ The shooting time per shot may be shorter than 20 seconds depending on the available space on the SmartMedia.
- ⚠ You cannot switch the LCD monitor off in this mode.
- ⚠ You may not be able to play back your movie on cameras other than the FinePix2600 ZOOM.

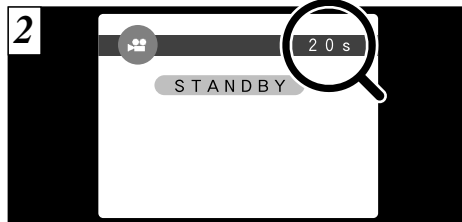

The available shooting time and the “**STANDBY**” message are shown on the LCD monitor.

■ SmartMedia standard shooting time

SmartMedia Capacity	Available shooting time
MG-4S (4MB)	Approx. 23 sec.
MG-8S (8MB)	Approx. 47 sec.
MG-16S/SW (16MB)	Approx. 94 sec.
MG-32S/SW (32MB)	Approx. 191 sec.
MG-64S/SW (64MB)	Approx. 385 sec.
MG-128SW (128MB)	Approx. 774 sec.

* These shooting times are for newly formatted SmartMedia. **47**

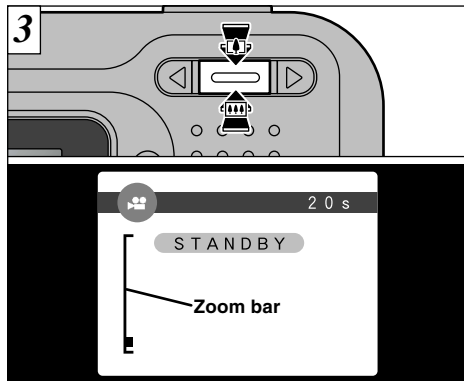

In Movie mode, the lens is locked in the wide-angle setting and only the digital zoom can be used. You can use “[ZOOM IN]” and “[ZOOM OUT]” to zoom in and out. A “zoom bar” is displayed on the LCD monitor.

● **Digital zoom focal distance (35mm camera equivalent)**

Approx. 38 mm to 95 mm
Maximum zoom scale: 2.5x

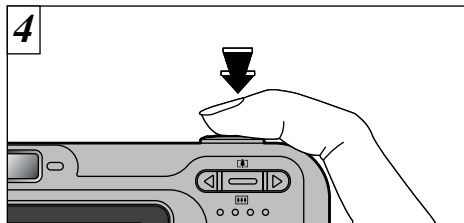

Press the shutter button down fully to start shooting the movie.

- ⚠ When you press the shutter button, there is a very brief delay before the camera starts shooting.
- ⚠ You do not need to hold down the shutter button.
- ⚠ The focus is fixed at 80 cm (2.6 ft.) to infinity.
- ⚠ The focus and white balance are fixed during shooting, but the exposure varies automatically to suit the scene being shot.

The white balance is set automatically when you press the shutter button down fully.

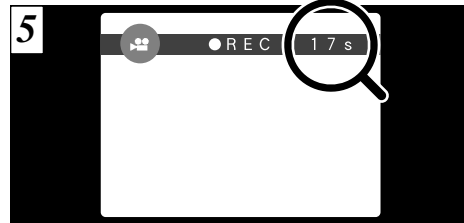

During shooting, “●REC” appears on the LCD monitor and the remaining time is displayed in the top-right corner.

- ⚠ Once the remaining time runs out, movie shooting automatically ends and the movie is stored on the SmartMedia.

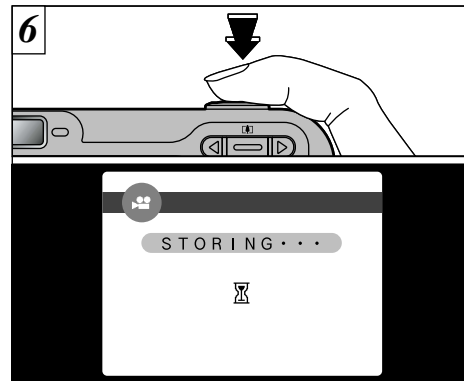

If you press the shutter button again during shooting, shooting ends and the movie is stored on the SmartMedia.

- ⚠ The time required to record a 20 second movie (roughly 3 MB) is approximately 3 seconds.
- ⚠ If you start shooting and then immediately end shooting, only 3 seconds of movie is recorded onto the SmartMedia.

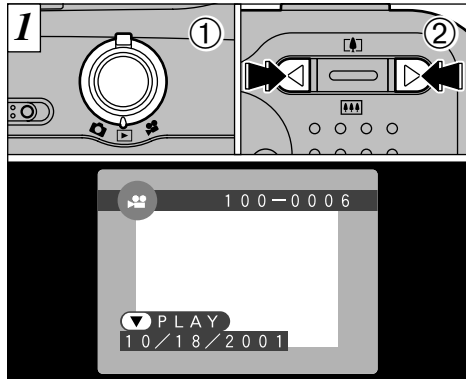

- ① Set the Mode switch to "▶".
- ② Use "◀" or "▶" to select the movie file.

⚠ Movies cannot be played back using multi-frame playback. Use the "DISP" button to revert to normal playback.

Movies are displayed somewhat smaller than still images.

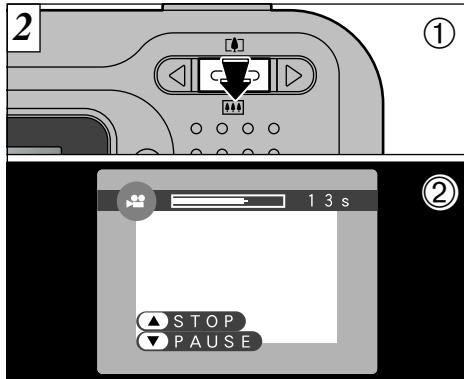

- ① Press "▼ (▶)" to play the movie.
- ② The LCD monitor shows the playback time and a playback progress bar.

⚠ If the subject of the movie is very bright, white streaks may appear on the image during playback. This is normal and is not a fault.

■ Playing Back Movies

	Control	Description
Playback		The movie automatically stops when playback ends.
Pause/Resume		During playback, press "▼ (▶)" to pause playback. Press "▼ (▶)" again to resume paused playback.
Stop		Stops playback. * Press "◀" or "▶" while movie playback is stopped to go back to the previous file or advance to the next file respectively.
Fast forward/Rewind	 Rewind Forward	During playback, press "▶" for fast forward and "◀" for rewind.
Skip playback	 When paused	<ul style="list-style-type: none"> • Each time you press "◀" or "▶" when the movie is paused, the movie advances or goes back one frame. • Hold the button down to advance or rewind frames continuously.

◆ Compatible movie files ◆

The FinePix2600 ZOOM can play back movie files shot on a FinePix2600 ZOOM and movie files up to 20 seconds long that were shot on a FUJIFILM digital camera and stored on a 3.3V SmartMedia. However, this camera cannot play back sound. If you attempt to play back a movie that is longer than 20 seconds, the "(! READ ERROR)" message appears and playback fails.

**FRAME**

Erase only the selected file.

- ! The file for which “! PROTECTED FRAME” was displayed cannot be erased. Unprotect the frame using the camera on which the protection was first applied.
- ! “! DPOF” is displayed for frames with DPOF settings and they cannot be erased (→P.82).

ALL FRAMES

All files are erased except those that are protected or that have DPOF settings. Copy any files that you want to keep to your hard disk beforehand.

FORMAT

Formatting erases all the files. Take particular care when formatting a SmartMedia as this procedure also erases all protected files and all files with DPOF settings. Copy any files that you want to keep to your hard disk beforehand.

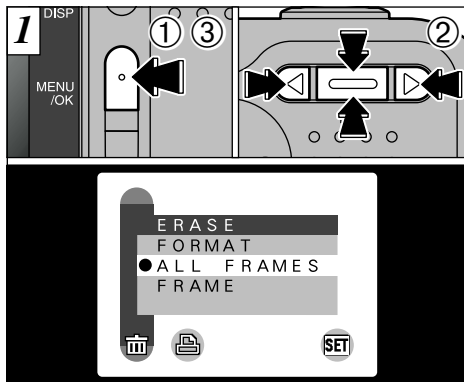

- ① Press the “MENU/OK” button to display the menu.
 - ② Use “◀” or “▶” to select “ ERASE” and then use “▲ (L)” or “▼ (R)” to select “FRAME”, “ALL FRAMES” or “FORMAT”.
 - ③ Press the “MENU/OK” button.
- ! Press the “BACK” button to exit the menu.

Formatting erases all the data on the SmartMedia, including protected files.

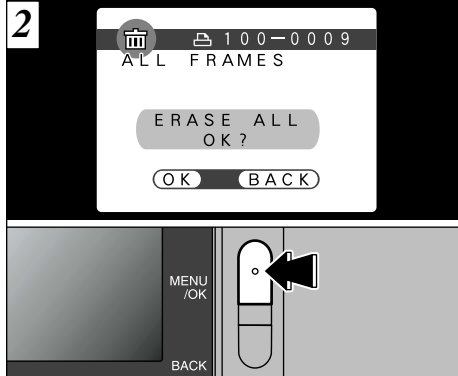

A confirmation message appears. In “FRAME” mode, use “◀” or “▶” to select the file and then press the “MENU/OK” button. When using “ALL FRAMES” or “FORMAT”, press the “MENU/OK” button.

- ! To cancel the frame erase procedure, press the “BACK” button.



DPOF stands for Digital Print Order Format and refers to a format that is used for recording printing specifications for images shot using a digital camera on media such as the SmartMedia. The recorded specifications include information on which frames are to be printed and how many prints of each frame are required.

This section gives a detailed description of how to order your prints with the FinePix2600 ZOOM.

- * Note that some printers do not support date and time imprinting or specification of the number of prints.
- * Note that the warnings shown below may be displayed while you are specifying the prints.

! DPOF (→P.82)

If the “! DPOF” message appears, you cannot erase the frame. Cancel the “DPOF” settings and then try again

! DPOF FILE ERROR (→P.82)

No more than 1000 frame;s can be specified on the same SmartMedia.

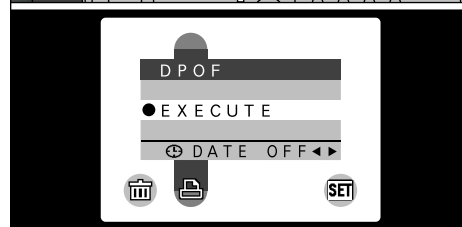
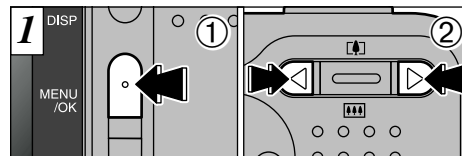

This function allows you to select whether or not the date of shooting is included on the print.

- ① Press the “MENU/OK” button to display the menu on the LCD monitor.
- ② Use “◀” or “▶” to select “DPOF”.

- ! The DPOF menu options do not appear when a movie file is selected.
- ! You may not be able to specify DPOF settings for some still shots taken on other cameras.

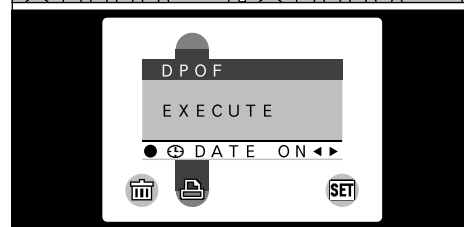
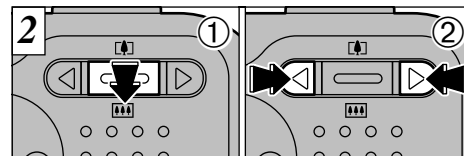

- ① Use “▼ (🔋)” to select “DATE”.
- ② Use “◀” or “▶” to specify “DATE ON” or “DATE OFF”. The selected setting is then valid for all frames with DPOF settings until the camera is switched off. Then specify the DPOF settings (→P.56).

- ! You must specify whether or not the date is included before you specify the DPOF settings.

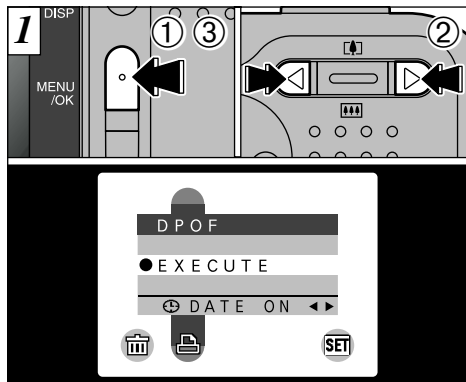

You can only specify one print per frame (image) in the DPOF settings.

- 1 Press the "MENU/OK" button to display the menu.
 - 2 Use "◀" or "▶" to select "DPOF".
 - 3 With "OK" selected, press the "MENU/OK" button.
- ! The DPOF menu options are not displayed during movie playback.
 - ! You cannot specify printing for more than one print per frame.

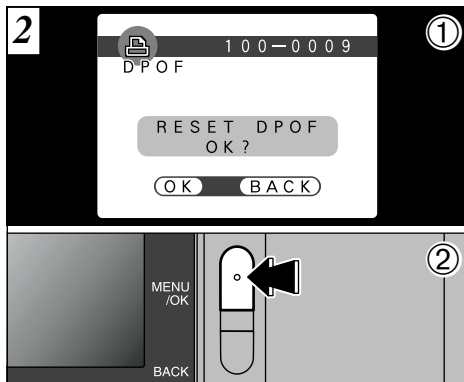

- 1 If you select a frame for which DPOF settings have already been specified, the "RESET DPOF OK?" message appears.
 - 2 Pressing the "MENU/OK" button erases all the DPOF settings already specified. You must then specify the DPOF settings again.
- ! Press the "BACK" button to leave the previous settings unchanged.
 - ! You can check the previous settings by playing back the images (→P.32).

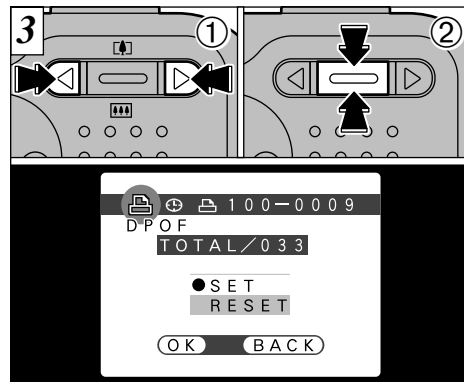

- 1 Use "◀" or "▶" to display the frame for which you want to specify DPOF settings.
 - 2 Use "▲ (L)" or "▼ (R)" to select the setting for the frame to be printed. If you have selected the date setting, the "⊕" icon is displayed.
- ! DPOF settings cannot be specified for movies.
 - ! Note that the "⊕" icon is not displayed during playback.
 - ! "TOTAL" shows the total number of frames for which prints have been ordered.

To specify more DPOF settings, repeat steps ① and ②.

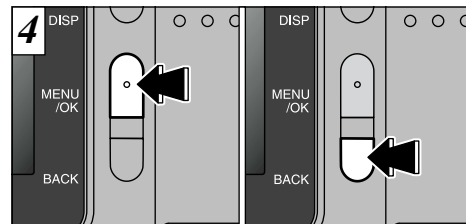

When you have finished specifying the DPOF settings, always press the "MENU/OK" button to confirm the settings. If you press the "BACK" button, no DPOF settings are specified.

- ! You can only specify one print per image in the DPOF settings. Also, the maximum number of frames for which you can specify print settings on the same SmartMedia is 999.

Pressing the "MENU/OK" button confirms all the settings. You cannot reset a portion of the settings without resetting them all.

The “Settings” chapter looks at functions available from “**SET**OPTION” in the “**📷**” still Image, “**🎥**” movie and “**▶**” playback.

■ List of Settings

📷 Still Image mode	🎥 Movie mode	▶ Playback mode
📷 AUTO	—	—
📷 MANUAL	—	—
🔊 QUALITY (P.60)	—	—
SET-UP	SET-UP	SET-UP
LCD BRIGHTNESS (P.61)	LCD BRIGHTNESS (P.61)	LCD BRIGHTNESS (P.61)

■ SET-UP menu options

Settings	Display	Factory default	Explanation
POWER SAVE	OFF/ON	OFF	This function prevents battery depletion by reducing power consumption when the camera is not being used. See P.62 for details.
USB MODE	DSC/PC CAM	DSC	See P.63 for details.
DATE/TIME	SET	—	You can use this to set the date and time. See P.19 for details.
BEEP 🎵	LOW/HIGH/OFF	LOW	This setting selects the volume of the beep emitted by the camera during camera operation.
LANGUAGE	ENGLISH/FRANCAIS	ENGLISH	Select English or French as the language used for screen display.

USING THE OPTION MENU

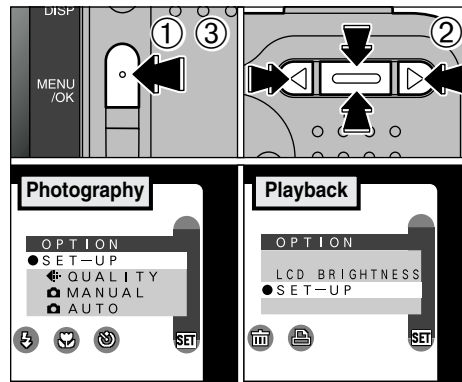

- ① Press the “MENU/OK” button to display the menu screen.
- ② Use “◀” or “▶” to select “**SET**OPTION” and “▲ (⏏)” or “▼ (⏏)” to select the desired setting.
- ③ Press the “MENU/OK” button to move to the selected setting.

Using SET-UP

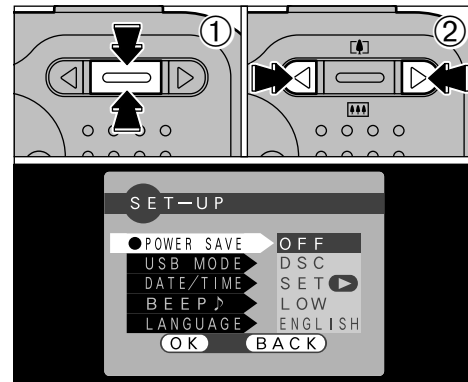



If you select “SET-UP”, the “SET-UP” screen appears.

- ① Use “▲ (⏏)” or “▼ (⏏)” to select the desired setting.
- ② Use “◀” or “▶” to change the setting.
Press the “MENU/OK” button to exit set-up.

🔊 Press “▶” for “DATE/TIME”.

SET SETTING THE FILE SIZE AND QUALITY (COMPRESSION RATIO)

You can choose any combination of 3 file sizes and 3 image quality settings. Use the table below as a guide to the best settings for your shots.

File size	FINE	NORMAL	BASIC
 2M (1600 × 1200)	①	①	②
 1M (1280 × 960)	②	②	—
 VGA (640 × 480)	—	③	—

- ①: For printing the whole image at A5 size (6 × 8 in.) or printing a part of the image at A6 size (4 × 6 in.)
- ②: For printing at A6 size (4 × 6 in.)
- ③: For use via the Internet as an e-mail attachment, etc.

Quality (compression ratio)

Select “FINE” for better image quality and “BASIC” to increase the number of available shots.

In most cases, the “NORMAL” setting provides more than adequate image quality.

-  There are 6 combinations of file size and quality settings in all. The number of available shots varies depending on the combination you select (→P.27).

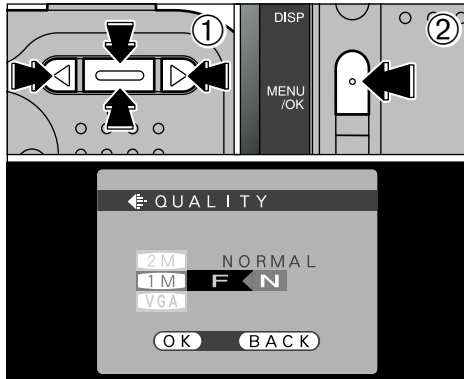

- ① Use “▲ (□)” or “▼ (■)” to change the file size setting and “◀” or “▶” to change the quality setting.
 - ② Press the “MENU/OK” button to confirm the setting.
-  To exit this procedure without changing the settings, press the “BACK” button.

SET LCD MONITOR BRIGHTNESS

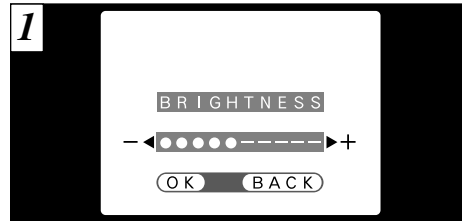

When you use the “LCD BRIGHTNESS” settings, an “adjustment bar” appears on the LCD monitor.

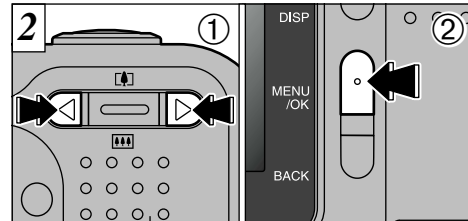

- ① Use “◀” or “▶” to adjust the LCD monitor brightness.
- ② Press the “MENU/OK” button to confirm the adjustment.

-  To exit this procedure without changing the settings, press the “BACK” button.

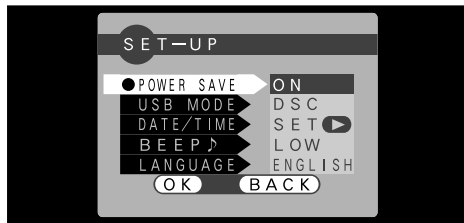

Once you enable this function, the LCD monitor is temporarily switched off to save power if you do not use the camera for 30 seconds. Use this function to gain the maximum possible run time from your batteries.

⚠ The charging time for the flash increases slightly because the flash charging power is reduced.

Sleep mode does not operate when the LCD monitor is switched off, during playback mode or during SET-UP, but the camera does automatically switch off if it is not used for approximately 2 minutes (AUTO POWER OFF).

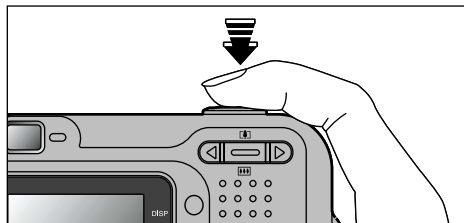

When the Power Save function is operating, press the shutter button down halfway to return the camera to the “ready to shoot” status. This is a useful feature as it allows you to take pictures more quickly than switching the camera off and then on again.

- ⚠ When the Power Save function is operating, pressing the shutter button down fully returns the camera to the “ready to shoot” status and takes the picture.
- ⚠ Power Save/Auto Power Off does not function when a USB connection is being used.
- ⚠ Operation can also be restored by pressing buttons other than the shutter button.

PC Connection describes how to set up a USB connection and provides an overview of the functions available using a USB connection. Refer also to the Software Quick Start Guide booklet.

DSC Mode

This mode provides a simple way to read images from a SmartMedia and store images on to a SmartMedia (⇒P.64).

PC CAM (camera) Mode

This function allows you to conduct videoconferencing sessions between PCs connected to the Internet. This function can also be used to record video on a PC (⇒P.66).

⚠ **Videoconferencing is not supported on Macintosh computers.**

◆ **The First Time You Connect Your Camera to a Computer** ◆

You must set up your computer as described below. Refer also to the Software Quick Start Guide booklet.

Windows

- ① Load the enclosed CD-ROM into your PC's CD-ROM drive and install the application software.
- ② With the CD-ROM loaded into your PC, select DSC connection mode and install the driver software.
- ③ With the CD-ROM loaded into your PC, select PC CAMERA connection mode and install the driver software.

Macintosh

Load the enclosed CD-ROM into the CD-ROM drive and install all the software.

CONNECTING AT DSC MODE

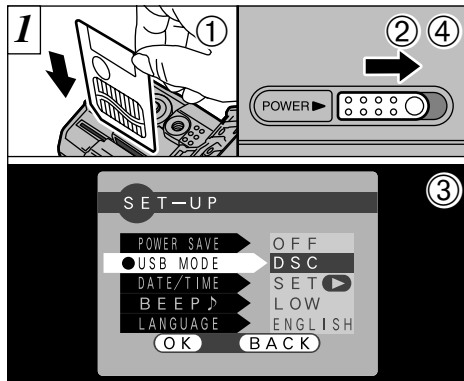

- 1 Load a SmartMedia containing photographed images into your camera.
- 2 Slide the Power switch sideways to switch the camera on.
- 3 Set the "USB MODE" setting in the "SET-UP" menu to "DSC" (⇒P.58).
- 4 Slide the Power switch sideways to switch the camera off.

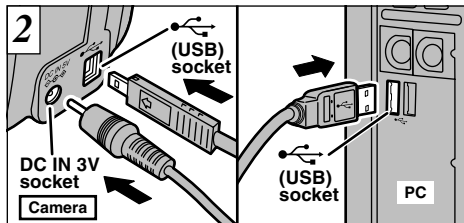

- 1 Switch your computer on.
- 2 Use the special USB cable to connect the camera to your computer.
- 3 Switch the camera on.

If you are connecting your camera to a Windows PC for the first time, the "Add New Hardware Wizard" window opens and driver software installation begins (⇒Software Quick Start Guide booklet).

Always use the prescribed procedure when disconnecting or switching off the camera (⇒P.68).

- ⚠ You should use the AC power adapter when the camera is connected to your computer (⇒P.21). Loss of power during data transmission can prevent successful data downloading.
- ⚠ Ensure that you insert the USB cable plugs into the correct sockets.
- ⚠ Push the cable plugs firmly into the connector sockets.

Camera Operation

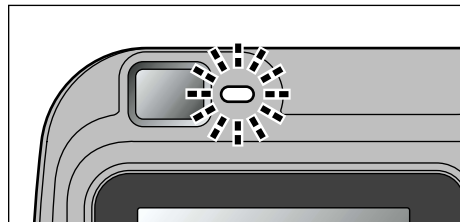

- The viewfinder lamp alternately blinks green and orange while the camera is communicating with your computer.
- "DSC" appears on the LCD monitor.
- Power Save/Auto Power Off does not function when a USB connection is being used.

- ⚠ Switch the camera off when you change the SmartMedia (⇒P.68).
- ⚠ Do not disconnect the USB cable when the camera is communicating with the computer. See P.68 for information on the disconnection procedure.

Computer Operation

- FinePixViewer automatically starts up.



* Screen for Windows 98 SE

- A removable disk icon appears and you can use your computer to transfer files to and from the camera.



If the above operations do not occur, you do not have the required software programs or drivers installed on your computer. Refer to the Software Quick Start Guide booklet and complete the required computer setup procedures. Then reconnect the camera to your computer.

CONNECTING AT PC-CAMERA MODE

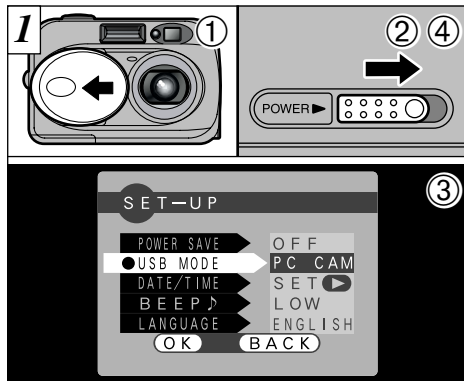

- ① Open the lens cover.
- ② Slide the Power switch sideways to switch the camera on.
- ③ Set the "USB MODE" setting in the "SET-UP" menu to "PC CAM" (⇒P.58).
- ④ Slide the Power switch sideways to switch the camera off.

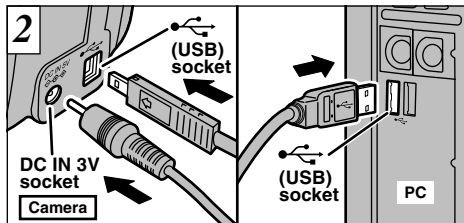

- ① Switch your computer on.
- ② Use the special USB cable to connect the camera to your computer.
- ③ Switch the camera on.

If you are connecting your camera to a Windows PC for the first time, the "Add New Hardware Wizard" window opens and driver software installation begins (⇒Software Quick Start Guide booklet).

Always use the prescribed procedure when disconnecting or switching off the camera (⇒P.68).

- ⚠ You should use the AC power adapter when the camera is connected to your computer (⇒P.21). Loss of power during data transmission can prevent successful data downloading.
- ⚠ Ensure that you insert the USB cable plugs into the correct sockets.
- ⚠ Push the cable plugs firmly into the connector sockets.

Camera Operation

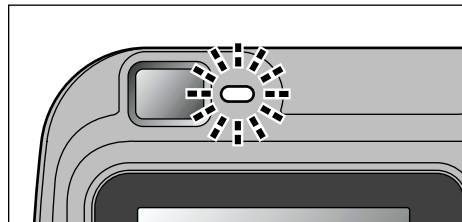

- The viewfinder lamp alternately blinks green and orange while the camera is communicating with your computer.
 - The lens is fixed at the wide-angle zoom setting.
 - "PC CAM" appears on the LCD monitor.
 - Power Save/Auto Power Off does not function when a USB connection is being used.
- ⚠ Do not close the lens cover while the camera and PC are communicating. If you close the lens cover, the "⚠ LENS COVER" warning is displayed and communication is interrupted.
 - ⚠ Do not disconnect the USB cable when the camera is communicating with the computer. See P.68 for information on the disconnection procedure.

Computer Operation

- FinePixViewer automatically starts up and the Picture Hello window opens (Windows only).



* Screen for Windows 98 SE

- You can use software such as VideoImpression to view live images.



* Macintosh screen

If the above operations do not occur, you do not have the required software programs or drivers installed on your computer. Refer to the Software Quick Start Guide booklet and complete the required computer setup procedures. Then reconnect the camera to your computer.

DISCONNECTING FROM THE PC (Important — always use this procedure.)

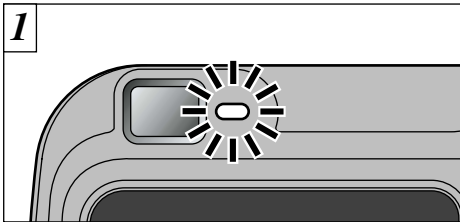

- 1 Quit all applications (FinePixViewer, VideoImpression, etc.) that are using the camera.
- 2 Check that the viewfinder lamp is glowing green (that the camera is not communicating with the computer).

For a PC CAMERA connection, proceed to step 3.

- 3 Even after the “Copying...” message is no longer displayed on your computer, communication with the camera may still be in progress. Always check that the viewfinder lamp on the camera is glowing green and is no longer flashing.

- 2 Perform the steps shown below before you switch the camera off. This procedure differs depending on the operating system software (or PC) you are using.

Windows 98 or 98 SE

No PC operation is needed.

Windows Me

Left-click the Eject icon in the taskbar and eject “USB disk”.



* Display this message and then click the “OK” button.

Windows 2000 Professional

Left-click the Eject icon in the taskbar and eject “USB Mass Storage”.



* Display this message and then click the “OK” button.

Macintosh

Drag the “Removable drive” icon on the desktop to the Trash.

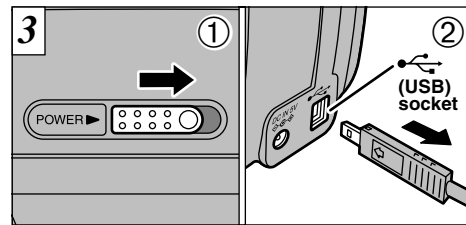

- 1 Switch the camera off.
- 2 Unplug the special USB cable from the camera.

- 3 If you are using Windows, you cannot disconnect the camera by right-clicking the removable disk icon (the camera) and selecting “Eject”. Always follow the proper procedure as given above before disconnecting the camera from your PC.

System Expansion Options

- By using the FinePix2600 ZOOM together with other optional FUJIFILM products, your system can be expanded to fill a wide range of uses.

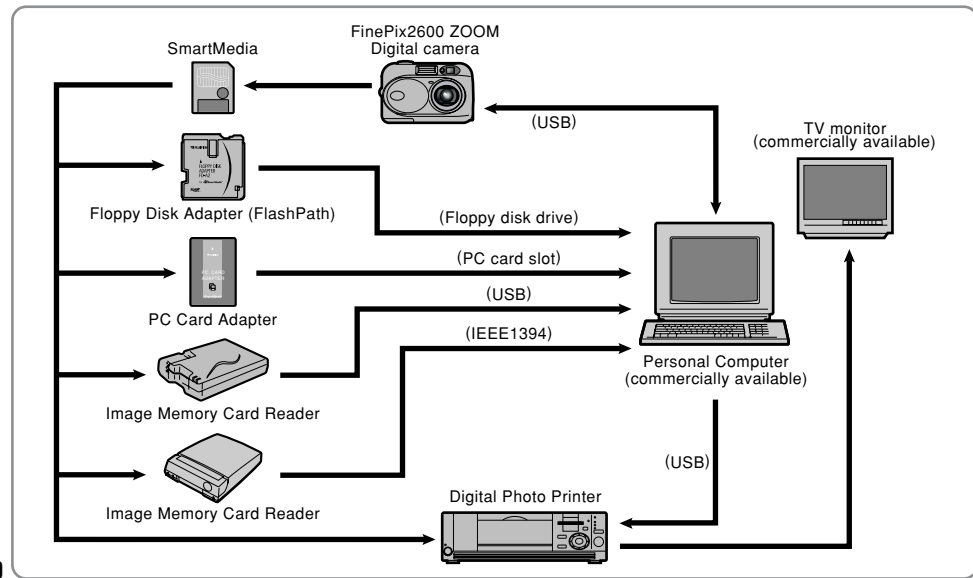

Accessories Guide

- The optional accessories (sold separately) can make taking pictures with the FinePix2600 ZOOM even easier. For information on how to attach and use the accessories, refer to the instructions provided with the accessory used.

● SmartMedia™

These are separately available SmartMedia cards.

Use the following SmartMedia:

- MG-4S: 4MB, 3.3V
 - MG-8S: 8MB, 3.3V
 - MG-16S/SW: 16MB, 3.3V
 - MG-32S/SW: 32MB, 3.3V
 - MG-64/SW: 64MB, 3.3V
 - MG-128SW: 128MB, 3.3V
- * Some 3.3V SmartMedia are labelled as "3V" or "ID" cards.

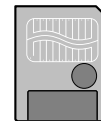

● AC Power Adapter AC-3V

Use the AC power adapter when you want to take pictures or play back images for long periods or when the camera is connected to a computer.

* The Shapes of the AC power adapter, the plug and socket outlet depend on the country.



● Fujifilm Rechargeable Battery 2HR-3UF

The 2HR-3UF includes 2 pieces of high-capacity AA-size Nickel Metal Hydride batteries.

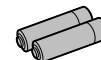

● Fujifilm Battery charger with Battery BK-NH (With Euro type or UK type plug)

The BK-NH includes the quick battery charger BCH-NH and 2 Ni-MH batteries.

The BCH-NH can charge 2 Ni-MH batteries in approximately 110 minutes.

Up to 4 Ni-MH or Ni-Cd batteries can be charged simultaneously.

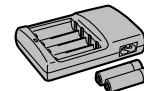

● SC-FX26

This is a special case made of polyester that protects the camera against soiling, dust and minor impacts when it is being carried.

● **FD-A2 Floppy Disk Adapter (FlashPath)**

This adapter is the same size and shape as a 3.5-inch floppy disk. You can copy the images on a SmartMedia to your PC simply by loading the SmartMedia into the floppy disk adapter and then inserting the adapter into your floppy disk drive.



	Compatible OS	Compatible SmartMedia
FD-A2	Windows 95/98/98SE/Me/NT4.0 Mac OS 7.6.1 to 9.1	5V/3.3V, 2MB to 128MB

● **SM-R2 Image Memory Card Reader**

The SM-R2 provides a quick and easy way to transfer images back and forth between your PC and an image memory card (SmartMedia). The SM-R2 uses the USB interface for high-speed file transfer.

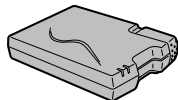

- Compatible with Windows 98/98SE, Windows Me, Windows 2000 Professional, iMac or Power Macintosh PCs which support USB as standard.

● **DM-R1 Image Memory Card Reader**

This device provides a simple way to transfer image data in either direction between your PC and an image memory card (SmartMedia or CompactFlash Type II (Microdrive-compatible)).



The IEEE 1394 interface provides high-speed data transfer.

- Compatible with Windows 98SE, Windows 2000 Professional (read-only), iMacDV and Power Macintosh PCs with FireWire as a standard feature. Mac OS 8.5.1 to 9.1

● **PC-AD3 PC Card Adapter**

The PC Card Adapter allows the SmartMedia to be used as a PC Card Standard ATA-compliant (PCMCIA 2.1) PC card (Type II).



- Compatible with SmartMedia of 5V/3.3V, 2MB to 128MB.

AF/AE Lock:

On the FinePix2600 ZOOM, pressing the shutter button down half way locks the focus and exposure settings (AF and AE lock). If you want to focus on a subject that is not centered in the frame or change the picture composition after the exposure is set, you can obtain good results by changing the composition after the AF and AE settings are locked.

DPOF: Digital Print Order Format

DPOF is a format used for recording information on a storage media (image memory card, etc.) that allows you to specify which of the frames shot using a digital camera are printed and how many prints are made of each image.

EV:

A number that denotes exposure. The EV is determined by the brightness of the subject and sensitivity (speed) of the film or CCD. The number is larger for bright subjects and smaller for dark subjects. As the brightness of the subject changes, a digital camera maintains the amount of light hitting the CCD at a constant level by adjusting the aperture and shutter speed.

When the amount of light striking the CCD doubles, the EV increases by 1. Likewise, when the light is halved, the EV decreases by 1.

JPEG:

Joint Photographics Experts Group

A file format used for compressing and saving color images. The compression ratio can be selected, but the higher the compression ratio, the poorer the quality of the expanded image.

Motion JPEG:

A type of AVI (Audio Video Interleave) file format that handles

images and sound as a single file. Images in the file are recorded in JPEG format. Motion JPEG can be played back by QuickTime 3.0 or later. You can use the following software to play back movies on your personal computer.

PC Card:

A generic term for cards that meet the PC Card Standard.

PC Card Standard:

A standard for PC cards determined by the PCMCIA.

PCMCIA:

Personal Computer Memory Card International Association (US).

White Balance:

Whatever the kind of the light, the human eye adapts to it so that a white object still looks white. On the other hand, devices such as digital cameras see a white subject as white by first adjusting the color balance to suit the color of the ambient light around the subject. This adjustment is called matching the white balance. A function that automatically matches the white balance is called an **Automatic White Balance function**.

Notes on Using Your Camera Correctly

- ▶ Be sure to read this information in conjunction with “Safety Notes” (→P.88) to ensure that you use your camera correctly.

■ Places to Avoid

Do not store or use the camera in the following types of locations :

- Very humid, dirty or dusty places.
- In direct sunlight or in places subject to extreme temperature rises, such as in a closed car in summer.
- Extremely cold places.
- Places subject to strong vibration.
- Places affected by smoke or steam.
- Places subject to strong magnetic fields (such as places near motors, transformers or magnets).
- In contact with chemicals such as pesticides or next to rubber or vinyl products for long periods of time.

■ Do not expose the camera to sand

The FinePix2600 ZOOM is particularly and adversely affected by sand. In sandy locations such as beaches or deserts, or in locations where there is wind borne sand, ensure that the camera is not exposed to sand. This can cause faults that may be irreparable.

■ Notes on Condensation

If the camera is carried suddenly from a cold location into a warm place, water droplets (condensation) may form on the inside of the camera or on the lens. When this occurs, switch the camera off and wait an hour before using the camera. Condensation may also form on the SmartMedia card. In this event, remove the SmartMedia and wait a short time before using it again.

■ When the Camera is Unused for Long Periods

If you do not intend to use the camera for a long period of time, remove the batteries and the SmartMedia card before storing the camera.

■ Cleaning Your Camera

- Use a blower brush to remove dust from the lens and LCD surface and then wipe lightly with a soft, dry cloth. If any soil remains, apply a small amount of lens cleaning liquid to a piece of FUJIFILM lens cleaning paper and wipe gently.
- Do not scratch hard objects against the lens, LCD monitor screen or viewfinder as these surfaces are easily damaged.
- Clean the body of the camera with a soft dry cloth. Do not use volatile substances such as thinners, benzene or insecticide, as these may react with camera body and cause deformation or remove the coating.

■ Using the Camera Overseas

When travelling overseas, do not place your camera in the check-in baggage. Baggage handling at airports may subject baggage to violent shocks, and the camera may be damaged internally even when no external damage is visible.

Notes on the Power Supply

Applicable Batteries

- Use AA-size nickel-metal hydride (Ni-MH) batteries in this camera.
AA-size lithium or manganese batteries cannot be used as they emit heat and can cause camera faults or damage.
- Only use alkaline batteries for emergencies. The capacities of alkaline batteries vary depending on the brand and the life of some batteries (the time for which they provide power) may be much shorter than others. You should also switch the LCD monitor off when using alkaline batteries.

Notes on the Batteries

Incorrect use of the batteries could cause them to leak, become hot, ignite or burst. Always observe the precautions given below.

- Do not heat the batteries or throw them into a fire.
- Do not carry or store a battery with metal objects such as necklaces or hairpins that could come into contact with the metal positive ⊕ and negative ⊖ poles of the battery.
- Do not expose the batteries to fresh or sea water, and take particular care to keep the terminals dry.
- Do not attempt to deform, disassemble or modify the batteries.
- Do not attempt to peel off or cut the battery casing.
- Do not drop, strike or otherwise subject the batteries to strong impacts.
- Do not use batteries that are leaking, deformed, discolored or exhibit any other obvious abnormality.

- Do not store batteries in very warm or moist locations.
- Keep the batteries out of the reach of babies and small children.
- When loading the batteries in the camera, ensure that the battery polarity (⊕ and ⊖) is as indicated on the camera.
- Do not use new batteries together with used batteries. In the case of rechargeable batteries, do not use charged and discharged batteries together. Do not use batteries of different types or brands together.
- If you do not intend to use the camera for a long period of time, remove the batteries from the camera. (Note that if the camera is left with the batteries removed, the time and date settings are cleared.)
- The batteries may feel warm immediately after being used. Before removing the batteries, switch the camera off and wait until the batteries cool down.
- When replacing the batteries, always fit 2 new batteries. Here, “new batteries” refers to batteries that were recently fully charged at the same time.
- Battery performance deteriorates at low temperatures (+10°C/+50°F or below) and the time for which they can be used shortens. This is particularly true of alkaline batteries. In cold conditions, put the batteries in your pocket or a similar place to warm them before loading them into the camera. If you use a body warmer to warm the batteries, ensure that they are not in direct contact with the warmer.
- Soil, such as fingerprints, on the battery terminals can significantly reduce the number of available shots. Carefully wipe the battery terminals clean with a soft, dry cloth before loading the batteries.

Notes on the Power Supply

- ⚠ If any liquid at all leaks from the batteries, wipe the battery compartment thoroughly and then load new batteries.
- ⚠ If any battery fluid comes into contact with your hands or clothing, flush the area thoroughly with water. Note that battery fluid can cause loss of eyesight if it gets in your eyes. If this occurs, do not rub your eyes. Flush the fluid out with clean water and contact your physician for treatment.

■ Disposing of Batteries

When disposing of batteries, do so in accordance with your local waste disposal regulations.

■ Notes on using compact rechargeable batteries (Ni-MH batteries)

- To charge AA-size Ni-MH batteries, follow the correct charging procedure using the special charger provided or the optional fast charger.
- Do not use the battery charger to charge batteries other than those specified for use with the charger.
- Note that the batteries may feel warm immediately after being charged.
- Ni-MH batteries are not charged at shipment.
- The camera mechanism is such that it draws a minute amount of current even when the camera is switched off. Note particularly that Ni-MH batteries will become over-discharged if left in the camera for a long period and will no longer be usable even if recharged.
- Ni-MH batteries self-discharge even when they are not being used. Always charge Ni-MH and Ni-Cd batteries before using them. If the time for which a battery provides power shortens markedly when it has been correctly

charged, this indicates that the battery has reached the end of its effective life and should be replaced.

- Soil (fingerprints, etc) on the terminals of Ni-MH batteries can greatly reduce the number of available shots. When this occurs, clean the terminals carefully with a soft dry cloth. Then use up the remaining charge in the batteries and recharge them.
 - Newly purchased batteries or batteries that have been left unused for an extended period may not be fully charged. (This is indicated by the immediate display of the battery low warning or a low number of available shots.) This is a normal characteristic of the batteries and does not indicate a fault. Repeatedly charging and using the batteries 3 or 4 times will restore them to a normal condition.
 - If you repeatedly charge a Ni-MH battery before it is fully discharged, it will suffer from the "memory effect"*, causing the "battery low" warning to appear while there is still ample charge remaining in the battery. To restore the batteries to their normal condition, use up all the charge in the batteries before recharging them.
- * Memory effect: A phenomenon affecting the battery characteristics such that the apparent battery capacity decreases.

Notes on Using the Battery Charger

- Rechargeable batteries and the battery charger itself will become warm due to the power stored inside the batteries. This is normal and does not indicate a fault. Wherever possible, use the battery charger in a well-ventilated location.

- There may be vibration noises from inside the battery charger during use. This is normal and does not indicate a fault.
- Do not use the battery charger to charge batteries other than FUJIFILM HR-3UF Ni-MH batteries.
- The battery charger could cause interference if placed close to a radio during charging. In this event, move the radio and charger further apart.
- Do not touch the connections or contact points on rechargeable batteries with other metal objects as this can cause a short circuit.
- Do not leave the battery charger in the following locations: Locations subject to strong vibrations, in very dusty locations, or in locations with very high humidity or high temperatures, such as close to a heating appliance or in direct sunlight.
- The battery charger accepts input voltages of 100-240 V AC at 50 or 60 Hz and can be used outside Japan. However, because the shapes of power sockets vary by country and by region, an appropriate plug adapter is also required for each country. Consult your travel agent for details.

BC-NHS Battery Charger Specifications

Rated input	100 – 240 V AC, 50/60 Hz
Input capacity	100 – 240 V ~ 0.07 A
Rated output	1.2 V DC, 400 mA × 2
Applicable batteries	FUJIFILM HR-3UF (Ni-MH, 1600 mAh or 1700 mAh)
Charging	HR-3UF (1600 mAh): Approx. 4.5 hours

time	HR-3UF (1700 mAh): Approx. 5 hours
Dimensions	90 mm × 68 mm × 26.5 mm (3.55 in. × 2.7 in. × 1.05 in.) (L × W × D)
Mass (Weight)	Approx. 85 g (3.0 oz) (excluding batteries)
Operating temperatures	0°C to + 40°C (+ 32°F to + 104°F)

Notes on Using the AC Power Adapter

Always use the AC-3V AC Power Adapter (sold separately) with the FinePix2600 ZOOM.

The use of an AC power adapter other than the AC-3V could result in damage to your camera.

- Ensure that you do not touch the contact areas on the AC power adapter against any other metal object as this could cause a short circuit.
- Do not plug in the AC power adapter while you are operating the camera using batteries. Switch the camera off first.
- Do not load the batteries while you are operating the camera using the AC power adapter. Switch the camera off first.
- If you disconnect the AC power adapter when there are no batteries in the camera, the date and time settings will be lost and must be reset.

Notes on the SmartMedia™

■SmartMedia

The SmartMedia card supplied with your FinePix2600 ZOOM camera is a new image recording medium developed especially for use in digital cameras. Each SmartMedia card contains a built-in semiconductor memory chip (NAND flash memory) which is used for storing digital image data.

Because the data is stored electronically, the stored image data can be erased from the card and new data recorded.

■SmartMedia with ID

The SmartMedia ID is a SmartMedia that has an individually assigned identification number. SmartMedia ID cards can be used with devices that use ID numbers for copyright protection or other purposes. This camera accepts SmartMedia ID cards in the same way as conventional SmartMedia cards.

■Storing Data

In the situations listed below, recorded data may be erased (destroyed). Please note that Fuji Photo Film Co., Ltd. accepts no responsibility whatsoever for the loss (destruction) of recorded data.

- * When the SmartMedia is used incorrectly by the owner or a third party
- * When the SmartMedia is exposed to static electricity or electrical noise

- * When the SmartMedia cover is opened or the SmartMedia removed, or when the camera is switched off during data recording, during data erasing (SmartMedia formatting) or during frame advance when images are being played back.

**Back up important data onto another medium.
(MO disk, floppy disk, hard disk, etc.)**

■Notes on Handling SmartMedia

- When inserting a SmartMedia, take care to hold it straight when pushing it into the camera.
- Never remove the SmartMedia or switch the camera off during data recording, during data erasing (SmartMedia formatting) or during frame advance when images are being played back. These actions could result in damage to the SmartMedia.
- Use only the SmartMedia specified for use with the FinePix2600 ZOOM. The use of other SmartMedia could damage the camera.
- SmartMedia are precision electronic devices. Do not bend, drop, or subject SmartMedia to excessive shocks.
- Do not use or store SmartMedia in environments likely to be affected by strong static electricity or electrical noise.

- Do not use or store SmartMedia in very hot, humid or corrosive environments.
- Take care not to touch the SmartMedia's contact area or allow the area to become soiled. Use a dry lint-free cloth to wipe away any soiling that does occur.
- To avoid damage caused by static electricity, always use the special static-free case provided during transportation or storage, or keep the SmartMedia in a storage case if available.
- Do not carry SmartMedia in locations such as a trouser pocket. This could subject the SmartMedia to excessive force when you sit down, thereby damaging the SmartMedia.
- The SmartMedia may feel warm when it is removed from the camera after extended periods of picture taking or image viewing. This is normal and does not indicate a fault.
- Inserting a SmartMedia that is charged with static electricity into your camera may result in a camera malfunction. If this occurs, switch the camera off and then on again.
- Affix the label onto the designated area of the card. Do not use third-party labels as this can lead to problems when the card is inserted or removed.
- When you attach the label, take care that it does not cover any of the write-protect area.

■Notes on Using SmartMedia with a PC







- If you intend to take photos using a SmartMedia that has been used on a PC, format the SmartMedia on your camera.
- When you format a SmartMedia in the camera and then shoot and record images, a directory (folder) is automatically created. Image data is then recorded in this directory.
- Do not change or delete the directory (folder) names or file names on the SmartMedia from your PC as this will make it impossible to use the SmartMedia in your camera.
- Always use the camera to erase image data on a SmartMedia.
- To edit image data, copy the image data to the PC's hard disk and then edit the copied data.





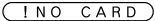

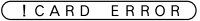
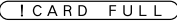
■Specifications

Type	Image memory card for digital cameras (SmartMedia)
Operating voltage	3.3V
Operating conditions	Temperature: 0°C to +40°C (+32°F to +104°F) Humidity: 80% or less (condensation free)
Dimensions	37 mm × 45 mm × 0.76 mm (1.45 in. × 1.77 in. × 0.03 in.) (W × H × D)

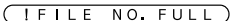
Warning Displays

► The table below lists the warnings that are displayed on the LCD monitor

Warning Displayed	Explanation	Remedy
 (Lit red)  (Flashing red)	The camera battery is low on charge.	Replace or recharge the battery.
	There is no SmartMedia loaded, or the SmartMedia loaded is a 5-volt card.	Load a SmartMedia (3.3-volt).
	<ul style="list-style-type: none"> The SmartMedia is not formatted. The SmartMedia terminals are soiled. Camera fault. 	<ul style="list-style-type: none"> Wipe the contact area on the SmartMedia with a soft dry cloth. It may be necessary to format the SmartMedia. If the error message is still displayed, replace the SmartMedia. Contact your FUJIFILM dealer.
	<ul style="list-style-type: none"> The SmartMedia terminals are soiled. The SmartMedia is damaged. The SmartMedia format is incorrect. Camera fault. 	<ul style="list-style-type: none"> Wipe the contact area on the SmartMedia with a soft dry cloth. It may be necessary to format the SmartMedia. If the error message is still displayed, replace the SmartMedia. Contact your FUJIFILM dealer.
	The SmartMedia is fully recorded.	Erase some images or use a SmartMedia that has ample free space.
	The SmartMedia is write-protected.	Use a SmartMedia that is not write-protected.
	<ul style="list-style-type: none"> An attempt was made to playback a frame not recorded on this camera. The SmartMedia terminals are soiled. You attempted to play a movie with a recording time longer than 20 seconds. 	<ul style="list-style-type: none"> Images cannot be played back. Wipe the contact surface on the SmartMedia thoroughly with a soft, dry cloth. In some cases, you may have to format the SmartMedia. You cannot play back movies that are more than 20 seconds long.

Warning Displayed	Explanation	Remedy
	The frame number has reached 999–9999.	Take the shots using a formatted SmartMedia.
	<ul style="list-style-type: none"> The data could not be recorded due to a SmartMedia error or a connection error between the SmartMedia and camera. The photographed image cannot be recorded as it is too large to fit in the available space on the SmartMedia. 	<ul style="list-style-type: none"> Re-insert the SmartMedia or switch the camera off and then on again. Use a new SmartMedia.
	There is a strong likelihood of camera shake because the shutter speed is slow.	Use flash photography. However, a tripod should be used for some scenes and modes.
	A protected frame was erased.	Protected files cannot be erased. Unprotect the frame using the camera on which the protection was first applied.
	Outside the AE continuous range.	The shot can be taken, but the exposure will not be correct.
	The AF (auto focus) cannot work effectively.	<ul style="list-style-type: none"> If the image is too dark, take the picture at a distance of around 1.5 m (4.9 ft.) from the subject. Use AF lock to take the picture.

Warning Displays

Warning Displayed	Explanation	Remedy
! DPOF	There is a print order specified for image you attempted to erase.	To erase the image, specify "RESET" as the DPOF setting.
! DPOF FILE ERROR	Prints were specified for more than 1000 frames in the DPOF frame settings.	The maximum number of frames for which prints can be specified on the same SmartMedia is 999.
! FOCUS ERROR ! ZOOM ERROR	Camera malfunction or fault.	<ul style="list-style-type: none"> • Switch the camera on again, taking care not to touch the lens. • Turn the camera off and on again a few times.
! LENS COVER	The lens cover is not open.	Open the lens cover.

Troubleshooting

▶ If you think the camera is faulty, check the following once more.

Problem	Cause	Remedy
No power.	<ul style="list-style-type: none"> • The battery is exhausted. • The AC power adapter plug has come out of the power outlet. 	<ul style="list-style-type: none"> • Load a new fully charged battery. • Plug the adapter back in.
Power cuts out during operation.	<ul style="list-style-type: none"> • The battery is exhausted. 	<ul style="list-style-type: none"> • Load a new fully charged battery.
Battery runs out quickly.	<ul style="list-style-type: none"> • Camera is being used in extremely cold conditions. • The terminals are soiled. • The battery is flat. 	<ul style="list-style-type: none"> • Put the battery in your pocket or another warm place to heat it and then load it into the camera just before you take a picture. • Wipe the battery terminals with a clean, dry cloth. • Load a new fully charged battery.
No photograph is taken when the shutter button is pressed.	<ul style="list-style-type: none"> • No SmartMedia is loaded. • The SmartMedia is fully recorded. • The SmartMedia is write-protected. • The SmartMedia is not formatted. • The SmartMedia contact area is soiled. • The SmartMedia is damaged. • The Auto Power Off function has switched the camera off. • The battery is exhausted. 	<ul style="list-style-type: none"> • Load a SmartMedia. • Load a new SmartMedia or erase a frame. • Remove the write-protection. • Format the SmartMedia. • Wipe the SmartMedia contact area with a clean dry cloth. • Load a new SmartMedia. • Switch the camera on. • Load a new fully charged battery.

Troubleshooting

Problem	Cause	Remedy
Can't use the flash to take pictures.	<ul style="list-style-type: none"> The flash is set to Suppressed Flash mode (The flash is closed). The shutter button was pressed while the flash was charging. The battery is exhausted. 	<ul style="list-style-type: none"> Set the flash to Auto, Red-eye Reduction or Forced Flash mode. (Some modes do not allow flash photography.) Wait until charging is completed before pressing the shutter button. Load a new full charged battery.
The playback image is too dark even though the flash was used.	<ul style="list-style-type: none"> The subject is too far away. The flash was covered by your finger. 	<ul style="list-style-type: none"> Move closer to the subject. Hold the camera correctly.
The image is blurred.	<ul style="list-style-type: none"> The lens is dirty. The lens is zoomed to telephoto in Macro mode. The photographed subject was too dark. 	<ul style="list-style-type: none"> Clean the lens. Cancel Macro mode. Try standing about 1.5 m (4.9 ft.) from your subject to take the picture.
There is speckling on the image.	<ul style="list-style-type: none"> The shot was taken with a slow shutter speed (long exposure) in a high-temperature environment. 	<ul style="list-style-type: none"> This is a characteristic of CCDs and does not indicate a camera fault.
Can't format the SmartMedia.	<ul style="list-style-type: none"> The SmartMedia is write-protected. 	<ul style="list-style-type: none"> Remove the write-protection. (Peel off the write-protect sticker.)

Problem	Cause	Remedy
<p>The ERASE ALL function does not erase all the frames.</p> <p>Frame erase does not erase the frame.</p>	<ul style="list-style-type: none"> The frame is protected. DPOF settings are specified for some frames. 	<ul style="list-style-type: none"> Unprotect the frame using the camera on which the protection was first applied. Cancel the DPOF settings for the frame and try again.
Nothing happens when I use the switches and buttons on the camera.	<ul style="list-style-type: none"> Camera malfunction. The battery exhausted. 	<ul style="list-style-type: none"> Remove the battery, re-insert and try again. Load a new fully charged battery.
The " !LENS COVER " warning or playback screen appears on the LCD monitor when the camera is connected to my personal computer.	<ul style="list-style-type: none"> The USB cable is not correctly connected to the personal computer or camera. The PC is not switched on. The lens cover is closed. 	<ul style="list-style-type: none"> Set up the camera and USB cable correctly. Switch the PC on. Open the lens cover fully.
The camera no longer works correctly.	<ul style="list-style-type: none"> The camera has suffered an unforeseen problem. 	<ul style="list-style-type: none"> Remove the battery briefly and then reload the battery and try again.

Specifications

System

- **Model**
Digital camera FinePix2600 ZOOM
- **CCD Sensor**
1/2.7-inch square pixel CCD
Total number of pixels: Approx. 2.11 million; Number of effective pixels: 2.0 million
- **Image file size**
1600 × 1200 pixels (1.92 million pixels)/1280 × 960 pixels/
640 × 480 pixels
- **File format**
Still image: JPEG (Exif Ver.2.1), DPOF-compatible
Movie : AVI format, motion JPEG
*Design rule for Camera File system compliant
- **Viewfinder**
Real image optical; Frame coverage: 80%

- **Lens**
Fujinon optical 3× zoom lens F3.5/F8.7
- **Storage media**
SmartMedia (3.3V)
- **Focus distance**
f = 6 – 18 mm (equivalent to 38 – 114 mm on a 35 mm camera)
- **Exposure control**
64 zones TTL metering, Program AE
(exposure compensation available in Manual mode)
- **Sensitivity**
Equivalent to ISO 100
- **White balance**
Auto (7 positions selectable in Manual mode)
- **Focal range**
Normal: Approx. 0.8 m (2.6 ft.) in. to infinity
Macro: Approx. 10 cm (3.9 in.) to 80 cm (2.6 ft.)
- **Shutter speeds**

■ Number of frames recorded

File Size	[2M] 1600 × 1200			[1M] 1280 × 960		[VGA] 640 × 480	Movie
	FINE	NORMAL	BASIC	FINE	NORMAL	NORMAL	
Image Data Size	Approx.770KB	Approx.390KB	Approx.200KB	Approx.620KB	Approx.320KB	Approx.130KB	—
4MB (MG-4S)	4	9	19	6	12	30	Approx. 23 sec.
8MB (MG-8S)	10	19	39	12	25	61	Approx. 47 sec.
16MB (MG-16S/SW)	20	39	75	25	49	122	Approx. 94 sec.
32MB (MG-32S/SW)	41	79	152	50	99	247	Approx.191 sec.
64MB (MG-64S/SW)	82	159	306	101	198	497	Approx.385 sec.
128MB (MG-128SW)	166	319	613	204	398	997	Approx.774 sec.

Variable-speed, 1/2 to 1/1000 sec. (Using AE)

- **Flash (Auto flash using flash control sensor)**
Effective range: Wide-angle Approx. 0.2 m – 3.0 m (0.6 ft. – 9.8 ft.)
: Telephoto Approx. 0.8 m – 3.0 m (2.6 ft. – 9.8 ft.)
Flash modes : Auto, Red-Eye Reduction,
Forced Flash, Suppressed Flash, Slow Synchro
- **LCD monitor**
1.8-inches, 72,000-pixels D-TFD
- **Self-Timer**
10 sec. timer clock

Input/Output Terminals

- **(USB) socket**
USB (1) for image data output with a personal computer
- **DC IN 3V (Power input) socket**
Special AC Power Adapter AC-3V

Power Supply and Others

- **Power supply**
Use one of the following:
 - 2AA-size Ni-MH (nickel metal hydride) batteries (provided)
 - AC Power Adapter AC-3V (sold separately)
- **Number of available shots using batteries (fully charged)**

Battery type	With LCD monitor ON	With LCD monitor OFF
Ni-MH battery HR-3UF	Approx.150 frames*	Approx.300 frames*

* With fully charged battery

This indicates the number of available frames shot consecutively at room temperature with a flash use rate of 50%.

- **Conditions for use**
Temperature: 0°C to +40°C (+32°F to +104°F); 80% humidity or less (no condensation)
- **Camera dimensions (W/H/D)**
99.8 mm × 65 mm × 53.9 mm/3.9 in. × 2.6 in. × 2.1 in.
(not including accessories and attachments)
- **Camera mass (weight)**
Approx. 200 g/7.1 oz (not including accessories, batteries or SmartMedia)
- **Mass (weight) for photography**
Approx. 255 g/9.0 oz (including batteries and SmartMedia)
- **Accessories**
See P.7
- **Optional Accessories**
See P.71, 72



* These specifications are subject to change without notice. FUJIFILM shall not be held liable for damages resulting from errors in this Owner's Manual.
* The LCD monitor on your digital camera is manufactured using advanced high-precision technology. Even so, small bright points and anomalous colors (particularly around text) may appear on the monitor. These are normal display characteristics and do not indicate a fault with the monitor. This phenomenon will not appear on the recorded image.
* The operation error may be caused in a digital camera by the strong radio interference (i. e. electric fields, static electricity, line noise, etc.).

Safety Notes



- To ensure that you use your FinePix2600 ZOOM camera correctly, read these Safety Notes and your Owner's Manual carefully beforehand.
- After reading these Safety Notes, store them in a safe place.





About the Icons







The icons shown below are used in this document to indicate the severity of the injury or damage that can result if the information indicated by the icon is ignored and the product is used incorrectly as a result.





	WARNING	This icon indicates that death or serious injury can result if the information is ignored.
	CAUTION	This icon indicates that personal injury or material damage can result if the information is ignored.

The icons shown below are used to indicate the nature of the information which is to be observed.







-  Triangular icons notify the user of information requiring attention ("Important").
-  Circular icons with a diagonal bar notify the user that the action indicated is prohibited ("Prohibited").
-  Filled circles with an exclamation mark notify the user of an action that must be performed ("Required").





 WARNING	
<p>If a problem arises, switch the camera off, remove the battery, disconnect and unplug the AC power adapter.</p> <p>Continued use of the camera when it is emitting smoke, is emitting any unusual odor, or is in any other abnormal state can cause a fire or electric shock.</p> <ul style="list-style-type: none"> • Contact your FUJIFILM dealer. 	 Unplug from power socket.
<p>Do not allow water or foreign objects to enter the camera.</p> <p>If water or foreign objects get inside the camera, switch the camera off, remove the battery and disconnect and unplug the AC power adapter.</p> <p>Continued use of the camera can cause a fire or electric shock.</p> <ul style="list-style-type: none"> • Contact your FUJIFILM dealer. 	
<p>Do not place the camera on an unstable surface.</p> <p>This can cause the camera to fall or tip over and cause injury.</p>	
<p>Never attempt to modify or disassemble the camera. (Never open the casing.)</p> <p>Do not use the camera when it has been dropped or the casing is damaged.</p> <p>This can cause a fire or electric shock.</p> <ul style="list-style-type: none"> • Contact your FUJIFILM dealer. 	 Do not disassemble.

 WARNING	
<p>Do not use the camera in the bathroom or shower.</p> <p>This can cause a fire or electric shock.</p>	 Do not use in the bathroom or shower.
<p>Never attempt to take pictures while in motion.</p> <p>Do not use the camera while you are walking or operating a moving car or other vehicle.</p> <p>This can result in you falling down or being involved in a traffic accident.</p>	
<p>Do not touch any metal parts of the camera during a thunderstorm.</p> <p>This can cause an electric shock due to induced current from the lightning discharge.</p>	
<p>Do not use the batteries except as specified.</p> <p>Load the batteries with the poles positioned as indicated by the ⊕ and ⊖ marks.</p>	
<p>Do not heat, modify or attempt to disassemble the batteries.</p> <p>Do not drop or subject the batteries to impacts.</p> <p>Do not attempt to recharge lithium or alkaline batteries.</p> <p>Do not store the batteries with metallic products.</p> <p>Any of these actions can cause the batteries to burst or leak and cause fire or injury as a result.</p>	

 WARNING	
<p>Use only the batteries or AC power adapter specified for use with this camera. Do not use voltages other than the power supply voltage shown.</p> <p>The use of other power sources can cause a fire.</p>	
<p>If the battery leaks and fluid gets into your eyes or comes into contact with your skin or clothing, this can cause injury or loss of eyesight. Immediately flush the affected area thoroughly with clean water and seek medical treatment.</p>	
<p>When discarding or storing batteries, cover the battery terminals with insulation tape.</p> <ul style="list-style-type: none"> • Contact with other metallic objects or batteries could cause the batteries to ignite or burst. 	
<p>Do not use the charger to charge batteries other than those specified here.</p> <p>The charger is designed for Fujifilm HR-AA NiMH batteries. Using the charger to charge conventional batteries or other types of rechargeable batteries can cause the batteries to leak fluid, overheat or burst.</p>	

Safety Notes

 CAUTION	
When charging ends, unplug the charger from the power socket. Leaving the charger plugged into the power socket can cause a fire.	
Do not use this camera in locations severely affected by oil fumes, steam, humidity or dust. This can cause a fire or electric shock.	
Do not leave this camera in places subject to extremely high temperatures. Do not leave the camera in locations such as a sealed vehicle or in direct sunlight. This can cause a fire.	
Keep out of the reach of small children. This product could cause injury in the hands of a child.	
Do not place heavy objects on the camera. This can cause the heavy object to tip over or fall and cause injury.	
Do not move the camera while the AC power adapter is still connected. Do not pull on the connection cord to disconnect the AC power adapter. This can damage the power cord or cables and cause a fire or electric shock.	

 CAUTION	
Do not cover or wrap the camera or the AC power adapter in a cloth or quilt. This can cause heat to build up and distort the casing or cause a fire.	
When you are cleaning the camera or you do not plan to use the camera for an extended period, remove the battery and disconnect and unplug the AC power adapter. Failure to do so can cause a fire or electric shock.	
Using a flash too close to a person's eyes may temporarily affect the eyesight. Take particular care when photographing infants and young children.	
Request regular internal testing and cleaning for your camera. Build-up of dust in your camera can cause a fire or electric shock. ● Contact your FUJIFILM dealer to request internal cleaning every 2 years.	

EC Declaration of Conformity

We
Name : Fuji Photo Film (Europe) G.m.b.H.
Address : Heesenstrasse 31
40549 Dusseldorf, Germany

declare that the product
Product Name : FUJIFILM DIGITAL CAMERA FinePix2600 ZOOM
Manufacturer's Name : Fuji Photo Film Co., Ltd.
Manufacturer's Address : 26-30, Nishiazabu 2-chome, Minato-ku,
Tokyo 106-8620, Japan

is in conformity with the following Standards

Safety : EN60950
EMC : EN55022 : 1998 Classe B
EN55024 : 1998
EN61000-3-2 : 1995 + A1:1998 + A2:1998

following the provision of the EMC Directive (89/336/EEC, 92/31/EEC and 93/68/EEC) and Low Voltage Directive (73/23/EEC).

CE

Dusseldorf, Germany

September 1, 2001

Place

Date

Signature/Managing Director



Bij dit produkt zijn batterijen geleverd. Wanneer deze leeg zijn, moet u ze niet weggooien maar inleveren als KCA



FUJI PHOTO FILM CO., LTD.

26-30, Nishiazabu 2-chome, Minato-ku, Tokyo 106-8620, Japan

Printed in Japan

Printed on recycled paper.

FGS-103107-FG