



**docking station : start guide**

## the OQO docking station

---

### what's in the box

- docking station with integrated optical drive
- HDMI-DVI adapter
- OQO docking station start guide

### introduction

You can transform your OQO *model 02* computer into a full featured desktop PC with the uniquely designed docking station. The docking station features an integrated slot loading optical drive, multiple ports for all your peripherals, and an adjustable arm and cradle for optimal screen viewing and portability.

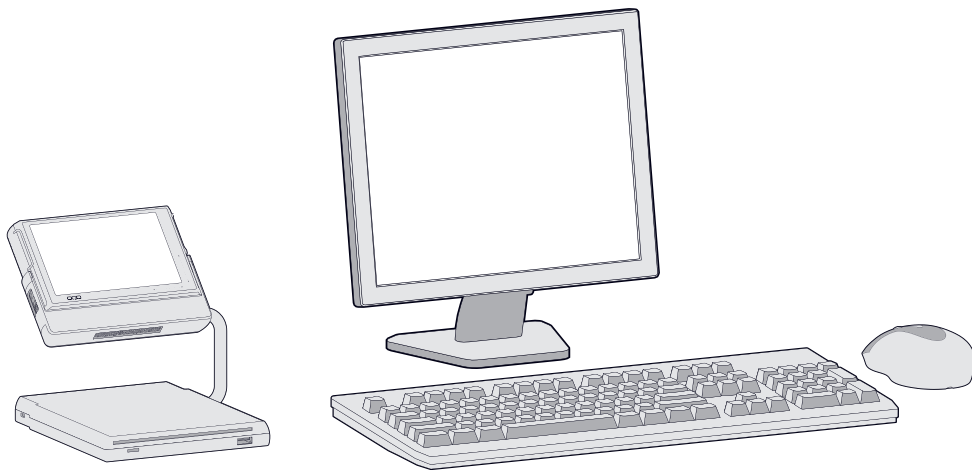

## using the OQO docking station

### folding and unfolding the docking station

To unfold the docking station, press down on the base of the docking station and lift the adjustable arm and cradle. Rotate the cradle towards you until it is fully upright (see diagram below). To collapse the docking station, rotate the cradle downwards and lower the cradle until the docking station is flat.

### docking and undocking the model 02

To dock the *model 02*, slide the computer into the cradle of the docking station. To undock the *model 02*, slide the display up to expose the thumb keyboard. With both hands holding the sides of the cradle, push your thumbs against the bottom edge of the display and lift the computer out of the cradle.

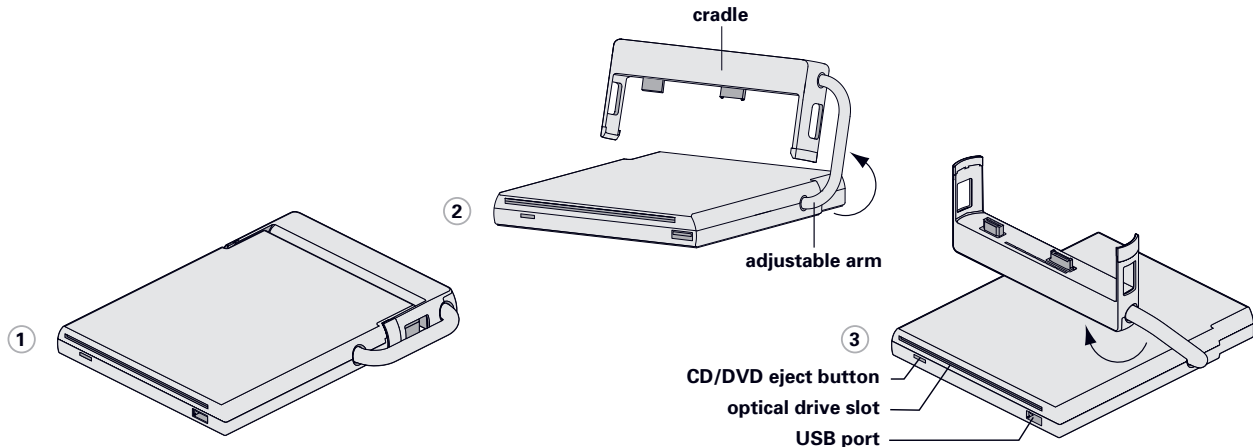

### connecting peripherals

The OQO docking station has multiple ports for all your desktop peripherals and connections. With both VGA and HDMI ports, the docking station can support simultaneous output to two external displays. To connect to a DVI display, use the supplied HDMI-DVI adapter. The docking station also has 3 USB ports (1 front + 2 back), Ethernet, and audio jack.

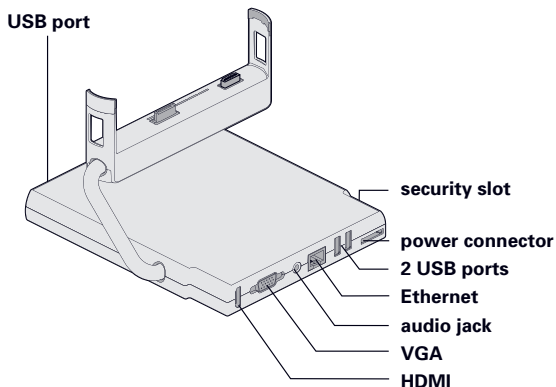

### using the optical drive

The OQO docking station has an integrated plug and play optical drive for reading and writing to optical media. To use the drive, the docking station must be powered by your computer power supply connected to an AC outlet or by a car/airplane adapter (optional).

### product support

The OQO support site provides additional information, including FAQs and articles and contact information for technical support. Access the support site at [www.oqo.com/support](http://www.oqo.com/support). You can also contact us by phone at 1-877-676-6688 or email [support@oqo.com](mailto:support@oqo.com).

Copyright © 2006 OQO, Inc. All rights reserved. This manual may not be copied, in whole or in part, without the written consent of OQO.

OQO, Inc.  
583 Shotwell Street  
San Francisco, CA 94110  
1-415-430-6200  
OQO Support 1-877-676-6688  
<http://www.oqo.com>

The information in this guide is subject to change without notice. OQO makes no warranty of any kind with regard to this manual, including, but not limited to, the implied warranties of merchantability and fitness for a particular purpose. OQO shall not be held liable for errors contained herein or direct, indirect, special, incidental, or consequential damages in connection with the furnishing, performance, or use of this material.

oqo